

NOTES

- \* THIS DRAWING IS PROPERTY OF **VK**. IT MUST NOT BE RETAINED, COPIED, REPRODUCED IN ANY FORM WITHOUT WRITTEN PERMISSION OF **VK**.
- \* USE ARCHITECTURAL DRAWING FOR DETAIL DIMENSIONS.
- \* IN CASE OF ANY DISCREPANCY IN THIS DRAWING OR DIFFICULTY AT SITE THIS OFFICE SHOULD BE REFERRED.
- \* DIAMETER OF SUB MAIN CONDUIT IS 1" AND REMAINING ARE OF 0.75".

SCHEDULE OF LEGEND

SYMBOL	DESCRIPTION
	18/23 WATT CFL LIGHT
	EXHAUST FAN POINT
	NETWORKING HUB
	E.P.B.X (TELEPHONE HUB)
	36W 2'X2' RECESS MOUNTED LED LIGHT
	22W LED TUBELIGHT (TUBE LIGHT)
	CEILING FAN
	5/6 AMP. 5 PIN SWITCH & SOCKET
	WALL FAN POINT (5/6 AMP. 5 PIN SOCKET)
	16 Amp. 5 PIN A.C. POWER SOCKET
	SWITCH BOARD WITH 5 Amp. SOCKET
	DISTRIBUTION BOARD (LIGHT/RAW/UPS)
	L.T. MAIN CONTROL PANEL
	CALL BELL
	UPS PRIMARY & SECONDRY PANEL
	WAY FOR POINT WIRING.
	WAY FOR NETWORKING & TELEPHONE.
	WAY FOR SUB MAIN WIRING.
	WAY FOR UPS DB WIRING.
	WAY FOR CIRCUIT WIRING.
	WAY FOR RAW POWER WIRING.
	WAY FOR UPS POWER WIRING.

LED Panel light designed for false ceiling suitable for watt fluorescent led lamp size (2'x2') complete as /boq

12 Watt led down light

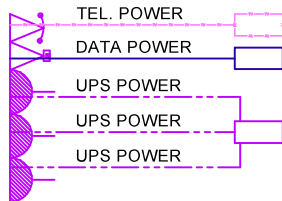

PROJECT

PROPOSED ELECTRICAL LAYOUT OF CHIRACHAS BRANCH

CLIENT

CANARA BANK

DRAWN BY

NORTH

CHECKED BY



SCALE

NOT TO SCALE

DATE

REVISION

17-06-24

SHEET TITLE

(ED-1)

DRAWING TITLE

ELECTRICAL LAYOUT

STAMP

ARCHITECT

VastuKriti

Jamshedpur, Patna

email. :- vastukriti108@gmail.com

email. :- vastukriti326@gmail.com

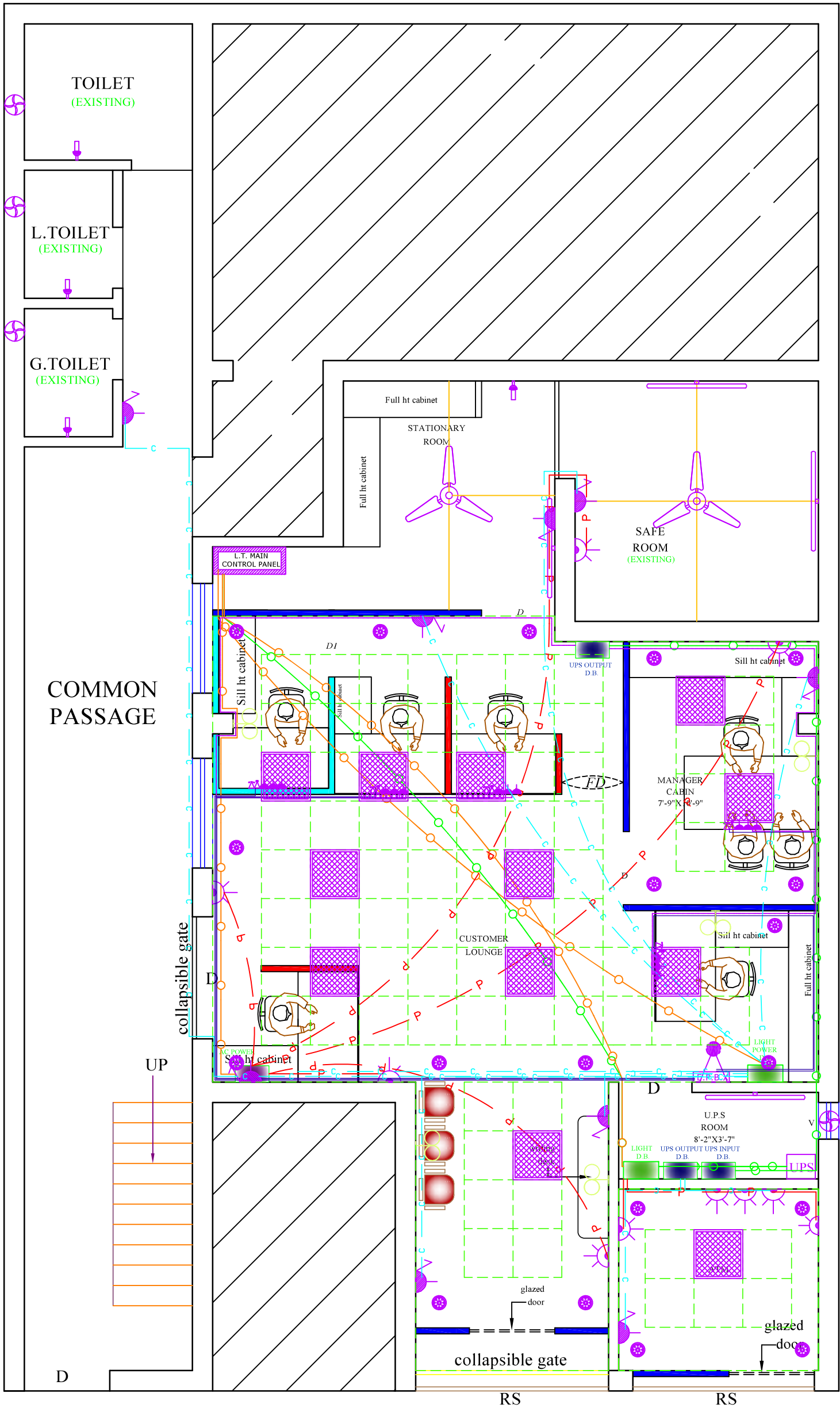

GROUND FLOOR PLAN

ROAD