

**CANARA BANK, GA SECTION, CIRCLE OFFICE, HYDERABAD**

From:  
 G A SECTION, Telephone: 040-27725221, 223  
 Circle Office, Canara Bank,  
 #10-3-163 & 10-3-163/A.  
 Plot No.85, Beside Rail Nilayam,  
 Secunderabad -500026  
 E-mail: pecohyd@canarabank.com

Date: 28.02.2025

**Notice Inviting Tender**

**WORK: Interior furnishing works in the premises of Kadthal Branch**

Location of the Branch/Office	Kadthal
Last date for submission of quotation	<b>07.03.2025 up to 3:00 pm</b>
Date & Time of opening quotation	<b>07.03.2025 up to 3:30 pm</b>
<b>Estimation of cost</b>	<b>Rs. 13.73 lakhs</b>
Time limit for execution of work	<b>21 days</b> from the date of work order
Defect liability period	12 months after completion of work
Retention money towards defect liability period	5 % of actual bill
Date of commencement of work	As per work order
Income Tax &/ other taxes	At applicable rate
Payment	After the completion of the work, as per procedure
Period for submitting final bill by contractor	Within one month from the date of virtual completion of the work
Liquidated damage for non completion of work in time	<b>1%(one per cent) of the Contract Value per week or part there off of delay subject to a limit of 10%(ten percent) of the Contract Value as "Liquidated damages" for the period during which the said works shall so remain incomplete or the Employer may deduct aforesaid sum towards such damages from any monies due to the Contractor.</b>
Insurance	At contractor's cost
Validity of submitted tender	60 days from the opening of tenders

SIGNATURE OF THE TENDERER



CANARA BANK, GA SECTION, CIRCLE OFFICE, HYDERABAD

Sealed tenders are invited on behalf of Canara Bank for the above mentioned work. The Bill of quantities, terms and conditions & layout are enclosed. **THE WORK IS TO BE EXECUTED IN A TIME BOUND MANNER. HENCE YOU ARE ADVISED TO PARTICIPATE IN THE TENDER ONLY IF YOU ARE WILLING TO START THE WORK IMMEDIATELY AND COMPLETE IT WITHIN 21 DAYS TIME FROM THE DATE OF WORK ORDER. SITE IS READY FOR IMMEDIATE UNDERTAKING OF THE TENDER WORKS.** The sealed tender must be dropped in tender box kept at the Circle Office within the above stipulated time. The tenders shall be opened at our office at the above specified time. The tenderers/ authorized representative are requested to be present at the time of opening. Canara Bank will not be bound to accept the lowest tender & reserves the right to reject any or all the tenders without assigning any reason thereof.

Place: Hyderabad  
Date: 28.02.2025

Sd/-

Assistant General Manager  
G A SECTION  
CO: Hyderabad

SIGNATURE OF THE TENDERER



CANARA BANK, GA SECTION, CIRCLE OFFICE, HYDERABAD

To

The Assistant General Manager,  
G A Section,  
Circle Office,  
Canara Bank,  
Hyderabad - 500026.

Respected Sir,

Sub: Interior furnishing works in the premises of Kadthal Branch.

I / We hereby submit our lowest tender for the above mentioned work as specified in the schedule. I / We have gone through all the specifications, terms and conditions of the contract. If this tender is accepted, I / We hereby agree to abide by and fulfill all the terms and conditions of this agreement & this tender shall constitute a binding contract between us.

Once again knowing fully well the contents of this tender, I / We sign this tender this .....Day of .....2025.

Witness of the Contractor

Address and Signature

Signature of the Contractor with seal & date

1.

2.

SIGNATURE OF THE TENDERER



CANARA BANK, GA SECTION, CIRCLE OFFICE, HYDERABAD

SPECIAL CONDITIONS

1. The works at the branch/Office premises need to be executed duly taking care of the local bye laws/regulations of the local authorities like Police Dept, Water supply and Sanitary Board, Electricity Board, Central/ State Labour Commission etc. Necessary permissions, licenses, temporary connections if needed shall be obtained by the Contractor and Bank shall not be held responsible for any lapses.
2. The works shall be executed duly taking care of all safety measures and Bank shall be fully indemnified for any 3<sup>rd</sup> party claims, casualties, mishaps, loss of property etc. related to the undertaking & the execution of the subject work.
3. Bank reserves the right to award the works to the second lowest (L2) bidder if the lowest bidder (L1) backs out.
4. GST TAXES: As per the new Goods & Services Tax (GST) structure, the tenderers are required to have GSTIN number & Tenderers without GSTIN number are not eligible to participate in the tender process. The details as per the Annexure I attached are to be mandatorily furnished along with the tender. The eligible tenderers are requested to quote the GST separately. The taxes will be deducted at source as per the statutory requirements. While raising the bill, it shall be mentioned as bill to Canara Bank and our Bank's GSTIN number to be mentioned.

CANARA BANK'S TELANGANA STATE GSTIN NUMBER IS AS BELOW: 36AAACC6106G3Z0

5. Tenderers are requested to submit Bid Security Declaration as per the format provided in the Tender Document

GENERAL RULES & INSTRUCTIONS FOR THE GUIDANCE OF TENDERER:

1. Tenderers are expected to visit the site before quoting the rates and should satisfy themselves as to the nature and conditions of work facilities available etc.
2. The tenderers are required to examine the enclosed general plan, tender form and conditions mentioned in the tender.
3. The tenderers should quote the rates in the figures. The amount for each item should be worked out and the requisite totals shall be given. The total amount shall be written both in figures and words.
4. The rates quoted in the tender shall be for measured finished works and shall include all changes including cost of materials, transportation, freight charges etc. complete.
5. The work is to be completed within **21 (TWENTY ONE)** days from the date of issuing work order/confirmation from our side or handing over vacant possession of the site whichever is later.

SIGNATURE OF THE TENDERER



**CANARA BANK, GA SECTION, CIRCLE OFFICE, HYDERABAD**

6. The successful tenderer shall give all necessary personal attention to the work during the process of work and also until the expiry date of “Defects Liability Periods” which is 12 months after the date of completion of the work.
7. The bank reserves the right to reject any portion of the work or material, which is, found unsatisfactory not up to the standard.
8. A retention amount of **5%** of the bill amount will be retained from the final bill and shall be paid to the successful tenderer after the defects liability period is over and upon the certification of the engineer.
9. Income tax deduction at prevailing / appropriate rates will be retained from each running bill which will be certified by the income tax authorities and a receipt will be given to the contractors.
10. GST will be decided as per the statutory requirements. Any other tax on materials, labour, services etc. in respect of this work shall be payable by the contractor and bank will not entertain any such claims.

**CONDITIONS OF CONTRACT**

Note: The requirement of these conditions shall be fulfilled by the tenderer without extra charges, the item rates quoted shall be deemed to have taken these conditions in to account.

1. If any additions and alterations are found necessary, the tenderer will have to do the same within the tendered rates with the prior approval of the bank.
2. The contractor shall employ adequate labour to complete the work within the scheduled time and shall make his own arrangements for housing his materials etc.
3. The contractor shall have to make his own arrangements to house his labour and staff for their services.
4. All tendered rates shall include for the cost of materials, labour, supervision, tools, plant, transportation, contingencies, duties, breakages, wastages, sundries, scaffolding, etc complete.
5. All instruction regarding the execution of the work shall be received from the officials through consultant/Bank only. Any other instructions issued directly to the contractor by anyone else shall not be binding on the bank.
6. The bank shall have the power to omit or cancel any item of work without assigning any reason whatsoever and no claim for compensation for damage will be entertained for such omissions and cancellation.
7. The contractor shall maintain satisfactory progress of work as well as maintain a desired level of workmanship. If in the opinion of the bank the progress is unsatisfactory and / or the workmanship is unsatisfactory then the bank shall take possession of the work within 7 days to that effect. The bank shall then complete the entire work and rectify all the defects at the contractor's cost and consequences.
8. In case the bank is not satisfied with the quality of materials used by the contractors, they reserve the right to direct the contractor to procure such materials supplied from agencies they deem fit.
9. The contractor is to be responsible for clearing any, all dirt and rubbish and superfluous materials as they accumulate and everything unnecessary and to leave the premises in a

**SIGNATURE OF THE TENDERER**



**CANARA BANK, GA SECTION, CIRCLE OFFICE, HYDERABAD**

clean and orderly condition on completion and fit for occupation. No extra payment shall be made for doing this.

10. Any work which is not approved by the bank shall have to be removed within 24 hours from the time of order and shall have to be redone by the contractor at his own cost and this cost will be borne by the contractor.
11. No deviation whatsoever for any reason will be permitted, however, if any deviation becomes necessary, the same should be brought to the immediate notice of the bank and written approval must be obtained for such deviation before proceeding with the execution of work.
12. The bank has got the right to supply any materials required for the work and cost of materials so supplied will be deducted from the bills of the successful contractor.
13. The contractor shall be responsible for safe custody of his material/materials issued to him by the bank till they are used for the work. He shall make his own arrangements for the safe custody and proper storage and preservation in sound condition till the same are actually used in the work.
14. The tenderer shall extended full co-operation to the other contractor /agencies like Furnishing, air conditioning, Fire & CCTV, LAN etc who are also working for the same project and co-ordinate with them in finishing the awarded work within the stipulated time given.
15. The contractor shall have a competent supervisor on the site for all the time.
16. For any new item the rate will be fixed by the bank as per prevailing fair market rate and labour which will be binding on the contractor.
17. In case the brand of materials mentioned in the tender is not available in the market, the alternate brand shall be used only after prior written approval of the bank.
18. The contractor shall be given a single electrical connection at work site. Electrical charges for consumption by the contractor will be charged separately by the bank, contractors have to provide sub-meter.
19. The successful tenderer shall not anticipate any financial help from the bank in the form of adhoc payment / advance for mobilizing and for starting the work.
20. The contractor should strictly adhere to the specifications and make of the materials, mentioned in the annexure. Any deviation will summarily reject the items of the work and not qualify for payment.
21. The successful tenderer shall be ready to carry out works between non banking hours and even at nights and holidays.
22. The contractor should sign all the pages of the document and the same shall be submitted to us.

Signature of the Contractor with seal & date

**SIGNATURE OF THE TENDERER**



CANARA BANK, GA SECTION, CIRCLE OFFICE, HYDERABAD

Acceptance of contractor for Labour laws

1. The successful tenderer / Contractor shall carefully and diligently implement the provisions of the Contract Labour Act & Contract Labour Rules.
2. The Bank shall be entitled to deduct from the Contract Consideration, any such amount which the Bank has to pay in accordance with the Contract Labour (Regulation & Abolition) Act 1971 and Workmen's Compensation Act, in the event of the Bank having to disburse compensation / effect any payment under the Contract Labour Acts / Rules.
3. Please note that as per rule 81(1) of Contract Labour (R&A) Rules, 1971, it is mandatory on the part of the Contractor to the display the notice containing the following details at prominent place at the work site.  
(a) Rates of wages. (b) Hours of work. (c) Wage periods. (d) Dates of payment of wages. (e) Names & addresses of the Labour Inspectors having jurisdiction & (f) Date of payment of unpaid wages.  
The notice containing the above details shall be displayed without fail at the work site.
4. The Contractor shall not engage any workmen for wages, less than the minimum wages prescribed under the notification issued by the Central Government.
5. The contractor should follow all labour laws/guidelines laid down by central /state government from time to time.

CERTIFICATE

I / WE HAVE READ, FULLY UNDERSTOOD THE ABOVE MENTIONED REGULATIONS OF LABOUR LAWS/GUIDELINES AND ACCEPT THE SAME IN TOTO. I ALSO UNDERTAKE TO FOLLOW ALL LABOUR LAWS/GUIDELINES LAID DOWN BY CENTRAL /STATE GOVERNMENT FROM TIME TO TIME & INDEMNIFY THE BANK AUTHORITIES.

SIGNATURE OF THE CONTRACTOR WITH SEAL & DATE

SIGNATURE OF THE TENDERER



**CANARA BANK, GA SECTION, CIRCLE OFFICE, HYDERABAD**

**ANNEXURE I (TO BE MANDATORILY FURNISHED)**

1.	Name of the Contractor under the Contract Labour (Regulation and Abolition) Act, 1970 (37 of 1970)(if applicable)	
2.	LIN / PAN No	
3.	Email Id	
4.	Mobile No.	
5.	No. & date of Certificate of Registration/License*	
6.	Name of Person in charge of work	
7.	LIN / PAN No. of the person in charge of work	
8.	Email Id of the person in charge of work	
9.	Mobile No. of the person in charge of work	
10.	The Nature of work involved & the facilities, including any plant & machinery provided in the case of a building or other construction work	
11.	The arrangement for the storage of explosives, if any, to be used in the building or other construction work	

\* Please strike off whichever is not applicable

SIGNATURE OF THE CONTRACTOR WITH SEAL & DATE

SIGNATURE OF THE TENDERER





**CANARA BANK, GA SECTION, CIRCLE OFFICE, HYDERABAD**

**APPROVED LIST OF MATERIALS**

1	Wood: All wood must be well seasoned, free from knots, other defects, decay and defects due to handling and transportation. Wherever necessary provide with anti termite treatment.	Sal wood/ Thali wood (imported)
2	Teak Wood	Old Burma Teak
3	Plywood Bwp 710 Cm/L	Greenply Gold/ Century Club prime/ Archid Classic/ Nikon Ply.
4	Veneers	Anchor/Green Ply / Century / Euro
5	Laminate: Design , shade, finish as per Bank's Selection confirming to IS: 2046	Decolote- formica/ Marino/ mica Greenlam / Meriono / Euro/ Archid
6	Powder coated track, ceiling	Interarch, Vista - levotor, Luxalon
7	Hinges, tower bolts, handles	Brass oxidized/ epoxy powder coated ( heavy duty)
8	Glass, Float Glass	Saint-Gobain / Modiguard / Asahi
9	Adhesive materials	Fevicol ( pidilite make)
10	Powder coated aluminum partitions (15.20 micron two step electrical color process using polyester powder)	Jindal / Indal/ Hindal ( Heavy Gauge 1.2 mm th, 15.20 micron 2 Step thick electrical color process Using polyester powder)
11	Pre laminated boards confirming to IS: 12823: 1990	Novopon /Eco board (Exterior grade only)
12	Floor springs confirming to IS: 6315/ door closure confirming to IS: 3564	OZONE/ HAFELE
13	Fixtures	All hardware fittings & fixture are to be powder coated. Color, finish as per Bank's specification, Godrej makes.
14	Melamine Polish	Asian Paint / ICI / Nerolac
15	External Emulsion (Anti-flasking, Anti-fungal)	Asian (Ace)/ Nerolac/ Berger/Dulux Sample to be approved by the Bank.
16	Oil Bound Distemper	Asian / Nerolac/Berger/Dulux Sample to be approved by the Bank.
17	Synthetic Enamel Paint	Asian /Nerolac/Berger/Dulux. Sample to be approved by the Bank.
18	Automobile Duco paint	MRF / ICI / Asian
19	Carpet Tiles	Nylon carpet tile -shaw/Milliken/Bentley prince
20	Cement	ACC, UltraTech, Ambuja - 43 grade
21	Bricks	Burnt bricks with minimum strength of 35KG/Cm <sup>2</sup>
22	Hinges / drawers	Earl-Bihari Pvt Ltd, Godrej
23	Steel	HYSD bars with FE-415 grade
24	Vitrified tiles	Naveen / RAK / Nitco / Kajaria
25	Ceramic Tiles	H & R Johnson/Bell/Kajaria/Naveen /Spartek.
26	Glazed Tiles	H & R Johnson/Bell/Kajaria /Spartek/ Naveen
27	Tiles fixing adhesive	Algitle / Balgrout.
28	False Ceiling tiles	Armstrong or equivalent only

SIGNATURE OF THE TENDERER



**CANARA BANK, GA SECTION, CIRCLE OFFICE, HYDERABAD**

29	Italian Marble	Classic / Nitco / Elegance
30	Vertical / roller blinds	Hunter Douglas, Mac, Vista, Technifab
31	Wall paper	Marshall / ego / softek
32	Glass film	GARWARE OR EQUIVALENT
33	Drawers / cupboards Locks	Godrej / Yale / Haffele / Dorma Laxmi Make
34	Door Locks	SS finished Mortice lock of Laxmi make
35	PVC Pipes	Finolex /Prince
36	M.S.Pipes	Tata
37	Sanitary Ware	Parry ware /Hindustan sanitary
38	Granite slab 20 mm thick	Edges shall be rounded. Beveled.
39	Vinyl flooring (2mm thick)	Royal House
40	Door closure	Everite/ Godrej/ Hafele
41	Steel	Kamadhenu

Note: Samples are to be approved by Bank and Bank if any. Any brands indicated under the items specifications in the Bill of quantities will prevail over the above indicated makes.

**SIGNATURE OF THE CONTRACTOR WITH SEAL & DATE**

**SIGNATURE OF THE TENDERER**



**CANARA BANK, GA SECTION, CIRCLE OFFICE, HYDERABAD**

**BRANCH LAYOUT**

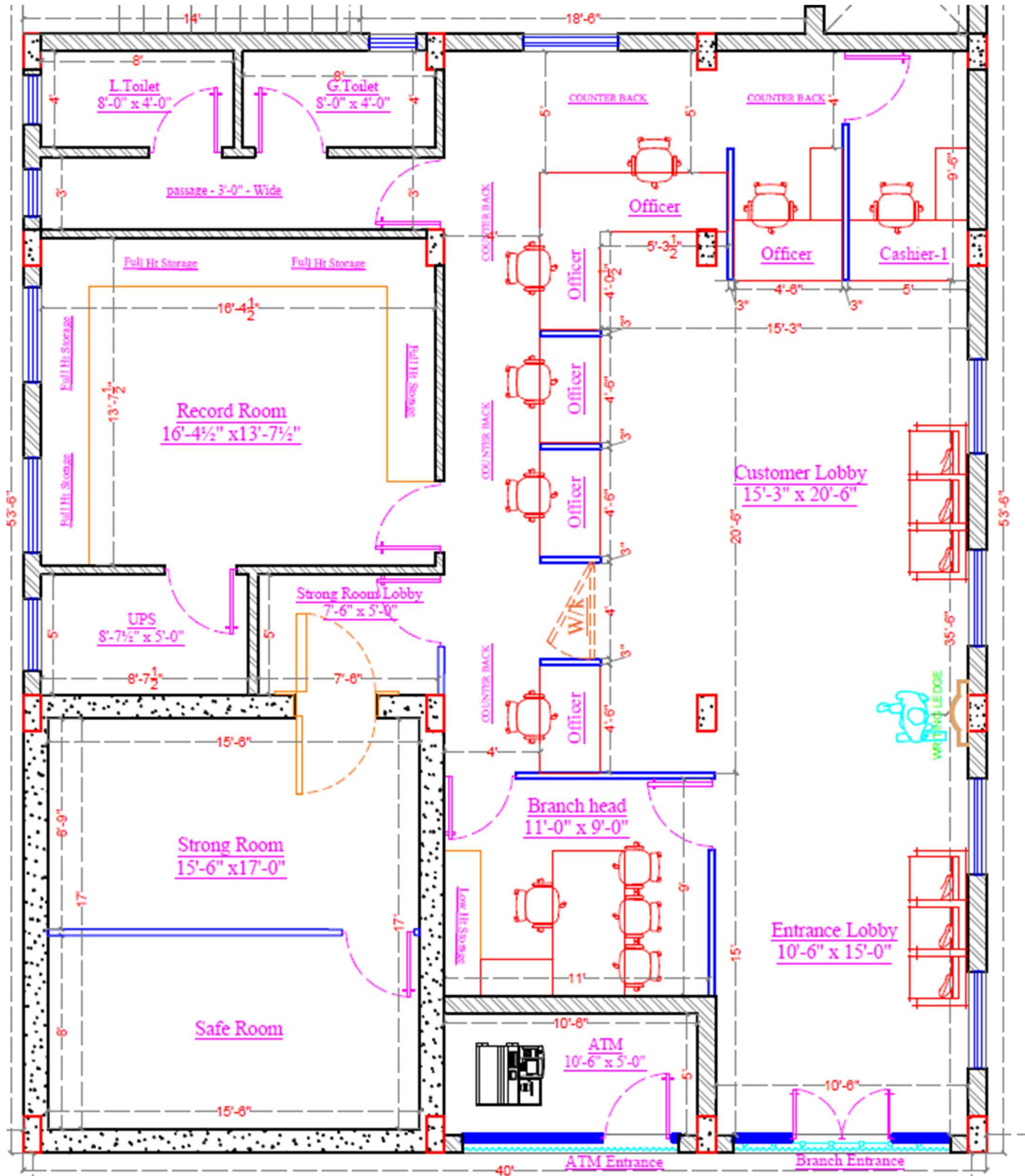

SIGNATURE OF THE TENDERER



**CANARA BANK, GA SECTION, CIRCLE OFFICE, HYDERABAD**

**PRICE - BID**

S.N	Description of Item	Unit	Qty	Rate	Amount
	<b>INTERIOR FURNITURE WORKS FOR BRANCH AND ATM</b>				
1	<b>GYPSUM BOARD FALSE CEILING</b>	Sft.	580.00		
	<p>Providing &amp; fixing as per design with suspended false ceiling consisting of 12mm.thk.Gyp. board suspended on G.I. framework to consists of G.I. perimeter channels 0.55 mm thk. x 20mm .x 30mm. along perimeter of false ceiling; screw fixed to wall/partition with nylon sleeves &amp; screws @ 600mm. dc. Suspending GI. Intermediate channels of size 0.9mm thk.x45mmx15mm. from the soffit at max. distance 1220mm. dc with ceiling angle 0.55mm. thk.x2n5mm.x10mm. Fixed to soffit using proprietary supplied GI. Cleats &amp; steel expansion fasteners. Ceiling section 0.55mm thk. xweb size 51.5mm &amp; flanges 26mm. Each &amp; 10.5 mm. lips fixed perpendicular to intermediate channel at 457mm. c/c Gyp board is screw fixed to ceiling section with 25mm. drywall screws at 230mm. c/c. boards to be finished with proprietary supplied jointing tape &amp; jointing compound &amp; sand papered to achieve a smooth finish etc. complete or as directed by the Bank/Bank. Gyp ceiling where necessary as normal specification Rate should include all types of cut-outs, grooves ,moulding &amp; plain troughs for tube lights / Down Lighter as directed by the designer. Note: Where RCC Slab is old and concrete is weal, the GI suspended channel shall be fixed with epoxy chemical and necessary load test to be carried out before fixing Gypsum board fixing. Rate shall be inclusive of epoxy chemical and fixing of suspenders with chemical no extra will be given for vertical and borders. Rate will be include with 2 to 3 coats of putty ,paper, till smooth finish with 2 to 3 coats as per the site requirement and site conditions.</p>				
2	<b>ARMSTRONG FALSE CEILING</b>	Sft.	560.00		

SIGNATURE OF THE TENDERER



**CANARA BANK, GA SECTION, CIRCLE OFFICE, HYDERABAD**

	<p>Providing and fixing of Armstrong make Mineral fibre Ceiling Boards in true horizontal level suspended on inter locking Grid system made of Hot Dip Galvanized steel sections powder coated XL -15 mm as per manufacturers specification including making opening for electrical and air conditioning fitting complete as directed. The tiles and grid system FRAMEWORK XL-15 mm Main Runner of 3000mm spaced at 1200mm centre fixed to soffit by approved hangers at 1200mm distance. First and last hanger should not be at a distance more than 450mm from the adjacent wall.XL-15 mm 1200mm cross Tee to be interlocked between Main Runner at 600mm centre to form 1200x600mm module 600mmx600mm module to be formed by fixing XL-15mm 600mm Cross Tee between centre of 1200mm Cross Tees.19X19 mm Wall Angle to be secured to wall at 450mm centers Suspension to be done by using 2mm pre-straightened GI wire using anchor fasteners. Make - Armstrong - ANS Micro &amp; Supra fine XL frame work. Note: Where RCC Slab is old and concrete is weal, the GI suspended channel shall be fixed with epoxy chemical and necessary load test to be carried out before fixing Gypsum board fixing. Rate shall be inclusive of epoxy chemical and fixing of suspenders with chemical.</p>				
3	<b>FULL HT SOLID PARTITION WITH DOORS</b>	Sft.	180.00		
	<p>Full Height Solid Partitions : Providing and Fixing of Full height partitions all made with Alumimium section Framework of 2" x 1" x 1.5mm Thickness with 2'0"x 2'0" c/c vertically and horizontally. Frame to be covered with 9 mm BWP plywood of (Century/Archid/Greenply) from both sides. 1mm thick laminate of (Century/heritage/Archid/Greenply) to be covered from both the sides of the partition. Frame should be properly fixed to the Floor, Vertical members should be firmly to the Slab and side wall available. Laminate should be considered up to two or three colour combination. All as per the design suggested at site and instructions of Engineer.(Frame work above false ceiling done for fixidity shall not be measured but contractor may factor it while quoting their rate as measurements up to false ceiling level only be taken). Plywood wherever mentioned Must be BWP GRADE AND IS 303, MARKED ISI.</p>				
4	<b>7-0" HEIGHT FULL GLAZED PARTITION - BRANCH MANAGER CABIN</b>	Sft.	65.00		

**CANARA BANK, GA SECTION, CIRCLE OFFICE, HYDERABAD**

	Providing and fixing frameless fully glazed 12mm thk toughened float glass fixed with necessary patch fittings (Dorma/Ozone/Godrej make) including cutting, making holes, cutouts in the glass of required shape and size to accommodate fittings and fixing the fittings in floors, soffits, jams including necessary fixtures, screws, sealant wherever required and SS cover over patch fittings. Rate shall include necessary etching film / LOGO, approved patch fitting locking systems, 1 pair of 12” long S. S. (C Shape) Handles of approved make, floor springs, and any necessary hardware items. Top Pivot , Top Patch Fittings, Bottom Patch fittings , Floor Spring , Corner lock with strike plate and Euro Profile Cylinder, C Shape Handle 25mm dia X 300mm length)				
5	<b>MANAGER CABIN DOOR</b>	Sft.	21.00		
	Providing and fixing frameless fully glazed 12mm thk toughened float glass fixed with necessary patch fittings (Dorma/Ozone/Godrej make) including cutting, making holes, cutouts in the glass of required shape and size to accommodate fittings and fixing the fittings in floors, soffits, jams including necessary fixtures, screws, sealant wherever required and SS cover over patch fittings. Rate shall include necessary etching film / LOGO, approved patch fitting locking systems, 1 pair of 12” long S. S. (C Shape) Handles of approved make, floor springs, and any necessary hardware items. Top Pivot , Top Patch Fittings, Bottom Patch fittings , Floor Spring , Corner lock with strike plate and Euro Profile Cylinder, C Shape Handle 25mm dia X 300mm length)				
6	<b>SEMI GLAZED PARTITION WITH DOOR - BRANCH MANAGER CABIN, CASH COUNTER</b>	Sft.	230.00		
	Providing and fixing frameless fully glazed 12mm thk toughened float glass fixed with necessary patch fittings (Dorma/Ozone/Godrej make) including cutting, making holes, cutouts in the glass of required shape and size to accommodate fittings and fixing the fittings in floors, soffits, jams including necessary fixtures, screws, sealant wherever required and SS cover over patch fittings. Rate shall include necessary etching film / LOGO, approved patch fitting locking systems, 1 pair of 12” long S. S. (C Shape) Handles of approved make, floor springs, and any necessary hardware items. Top Pivot , Top Patch Fittings, Bottom Patch fittings , Floor Spring , Corner lock with strike plate and Euro Profile Cylinder, C Shape Handle 25mm dia X 300mm length)				
7	<b>PARTLY GLAZED LOW HT PARTITION</b>	Sft	70.00		

**CANARA BANK, GA SECTION, CIRCLE OFFICE, HYDERABAD**

	Low Ht /Half Ht Solid Partitions: Same as Item no 3 but Low ht or Half height as per design & 9mm Glass with Etching design or One way vision film or design approved by the bank. Edges of the partition to be covered with 3"x1.5" Steam beach wood duly male mine polished moulding. All as per the design and instructions of the design in charge. ply wood wherever mentioned BWP GRADE IS 303,(AT WORK STATION AND BETWEEN OFFICERS FRONT TABLE				
8	<b>Manager Table ( 6'-0" x 3'-0" x 2'-6" ) with side unit</b>	No	1.00		
	Providing & fixing table made up of 18mm.thk.BWP Plywood frame with 10mm. thk. Clear glass on top. The table should be finished with 1.0 mm thk. Laminate on exposed plywood frame, inside edge of holes, polish from inside. The table shall be provided with single drawer, ply key board drawer , with ply footrest, wire manager ,& other required hardware. The glass shall have plain diamond edge polish on all four sides & hole for wire manager. The glass should cover the length of the table & width of side unit as shown in the drawing. Rate includes with side unit. Providing & fixing side unit made up of 18mm. thk. plywood framework & 6mm. thk. plywood as backing. Side unit should have 2 no. of drawers above & shutters below. Drawers should be made up of 19 thk. Plywood fascia, 12 thk. Plywood sides & 6 thk. Plywood bottom. Drawers should be mounted on heavy duty drawer sliders. Side unit should be finished with 1.0 mm. thk. Laminate of approved shade & colour on external surface. All exposed edges of 18 thk. & 12 thk. Plywood should have lipping patti All lipping patti's should be finished with french polish on it. The cost should include necessary hardware, handles, Godrej make locks with common handles, Godrej make locks with common key for set of drawers etc. complete as per design. Drawers to be made of 12 mm thick comm. plywood and finished with laminate on front and all un exposed surfaces shall be provided with 0.8mm thk laminate.				
9	<b>Cash Counter / Single window counter</b>	No	1.00		

**CANARA BANK, GA SECTION, CIRCLE OFFICE, HYDERABAD**

	<p>Providing and fixing CASH / SINGLE WINDOW COUNTER TABLE TOPS (5'-0" to 6'-0"X2'-9", side table of 3'-0"X1'-3") and Keyboard to be fixed for every cabin, in 18mm thk. marine BWP grade ply horizontals above in 20mm thk. black polished granite at customer ledge of 16" with edge grinding at nosing done at the corner surfaces fixed on top, front edges of ply to be 2" x 1" thk. TW frame on the outside, polished (1"x ¾") teak wood moulding / beading to all exposed edges of ply, 10mm thk clear glass on table top as per shape with cutting for wire manager. Each unit shall be provided with a sliding key board tray 2'-3" of wide with sliders, cupboard below the drawer with locking arrangements aluminum handle, brass hinges etc the front back &amp; top surface shall be laminated with 1.0mm thickshell finish laminate. The edges are to be neatly finished as per the shape indicated by Engineer in charge. complete as shown in drawing, Complete as shown in drawing. Rate Include with Second Top With Granite, Front Running Glass And Creating Voucher Tray as per the site Conditions and instructions given by the Bank and Engineer. All un exposed surfaces shall be provided with 0.8mm thk laminate.</p>				
10	<b>Officer/Clerk counter</b>	Rft	29.75		
	<p>Providing and fixing CLERICAL / OFFICER (counters) without side unit TABLE of 4'-0"/5'-0"X 2'-6", table made out of 18 mm BWP grade ply board (approved make )structure with edges fixed with teak wooden lipping ,having officer table top 2'-6" from the ground level &amp; 2'-6" clear top width. Each unit shall be provided with a sliding key board tray 2'-3" of wide with sliders, cupboard below the drawer with locking arrangements aluminum handle, brass hinges etc the front back &amp; top surface shall be laminated with 1.0mm thickshell finish laminate. 10mm thk plain glass on table top as per shape with cutting for wire manager. The edges are to be neatly finished as per the shape indicated by Engineer in charge. Provision for footrest of size 75mmx 38mm shall be made at the bottom. Wire manager shall be provided at the corner of the counter top. All exposed edges of the block shall be provided with teak wooden beading (3"x1"front side and 1"x 3/4" inner side) and polishing done etc. complete as shown in drawing. All un exposed surfaces shall be provided with 0.8mm thk laminate.</p>				





**CANARA BANK, GA SECTION, CIRCLE OFFICE, HYDERABAD**

11	<p>Providing &amp; fixing officers counter of 2'-6" height, L shaped work station of length 4'3" to 5'-0" on each side from corner and 2'-0 " width, Counter to be made up of 18mm. thk. BWP Plywood framework on all sides. The table shall be provided with single drawer above and storage unit with shutter &amp; magnetic catch below with all required hardware like sliders, SS handles and locks for both drawer and storage as a separate unit detachable from the work station as modular. The work station should also have ply key board drawer , with ply footrest, wire manager &amp; other required hardware. The table shall be provided with 10mm. thk. clear glass on top.</p>	Nos	-		
	<p>The glass shall have plain diamond edge polish on all four sides &amp; hole for wire manager. The glass should cover the entire length of the table on both sides as shown in the drawing. The counter should have necessary holes of required sizes for wire managers. The counter should have necessary passages &amp; ledges for data cables, electrical cables and telephone lines. The counter should be finished with 1.0mm. Thk. Laminate of approved color &amp; shade from external side and polish from inside. All the exposed edges of plywood including lower edges should have lipping patti ( preferred wood). Lipping patti should be finished in polish. The cost should include necessary hardware Moulding .handles &amp; Godrej make drawer locks with common key for cash drawers, footrest etc. complete as per design. Rate includes with 10mm Thick Glass Top on every counter.</p>				
12	<p><b>GLASS WORK</b> -Providing and fixing 12mm thick clear Toughened Glass of 18" height in front of public counters, cash counters &amp; elsewhere held together with SS clamps &amp; SS studs as per approved sample including providing and fixing etching film of 3M Make as per design, steam beach beadings (18x18mm), steam beach moulding (62 x 31mm) along with polish &amp; melamine spray finish etc. complete instructions given by the Bank.</p>	Rft	26.00		
13	<p><b>RUNNING COUNTER</b></p>	Rft	8.00		
	<p>Providing and fixing Running customer counter of of different lengths and height 30" and working top width of 30" width (all minimum dimensions) all as per drawing with front, working top, main vertical support upto the working top at every 5ft c/c and intermediate vertical support for draw unit upto working top. The working top shall be at a height of 30". There shall be two drawers of size 13"x 22"x</p>				



**CANARA BANK, GA SECTION, CIRCLE OFFICE, HYDERABAD**

	<p>5" (internal dimensions) fixed in between the intermediate support and main support at every 5ft c/c. The portion below the drawers shall have a cupboard with front shutter. The counter and the drawers shall be made by using 19mm thick MR Grade Commercial Plywood except for draw bottom which shall be provided with 12 mm MR grade commercial plywood. The customer top, working top, customer front &amp; front face of shutter and draw shall be finished with 1 mm thick lamination of approved shade .</p> <p>For every seating area (normally 4'6" to 5 feet length) there shall be a foot rest made of 3" x 2" hardwood section with proper painting finish. The drawers movement shall be with metal sliding channels with rollers. All the exposed edges shall be provided with beach wood beadings of size 19mm x 6mm and neatly polished. The unexposed surfaces except beadings shall be finished 0.8 mm thk laminate of approved make. Each drawer/cupboard shall have one multipurpose concealed lock and 3" long brass or stainless steel handle. Necessary openings for the access of the wires with plug shall be provided with PVC caps with silver tone for the counter top at appropriate location.</p> <p>(any change in the length shall be paid proportionately)</p>				
14	<b>Side Units</b>	Sft	32.50		
	<p>Providing &amp; fixing side unit made up of 19mm. thk. plywood framework &amp; 6mm. thk. plywood as backing. Side unit should have 2 no. of drawers above &amp; shutters below. Drawers should be made up of 19 thk. Plywood fascia, 12 thk. Plywood sides &amp; 6 thk. Plywood bottom. Drawers should be mounted on heavy duty drawer sliders. Side unit should be finished with 1.0 mm. thk. Laminate of approved shade &amp; colour on external surface. All exposed edges of 18 thk. &amp; 12 thk. Plywood should have lipping patti All lipping patti's should be finished with paint/french polish on it. The cost should include necessary hardware, handles, Godrej make locks with common handles, Godrej make locks with common key for set of drawers etc. complete as per design. Drawers to be made of 12 mm thick comm. plywood and finished with laminate on front and enamel painted inside. All un exposed surfaces shall be provided with 0.8mm thk laminate.</p>				
15	<b>Storage Units</b>	Sft	520.00		



**CANARA BANK, GA SECTION, CIRCLE OFFICE, HYDERABAD**

	Providing & fixing storage units made up 19 mm. thk. plywood framework, 6 mm. thk. plywood back as required as per design. Good quality blockboard shutters should be fixed on SS heavy hinges Storage units. should be finished with 1.0 mm. thk. laminate from external side & All un exposed surfaces shall be provided with 0.8mm thk laminate. All exposed edges of plywood should have lipping patti on it. Lipping patti should be finished with French polish on it. The cost should include necessary handles, magnetic catches, Godrej make locks, tower bolts on doors etc. complete as per design. 7'- 3' ht HEIGHT STORAGE				
16	<b>Writing Desk</b>	No	2.00		
	Providing & fixing writing desk made up of 19 thk. Double plywood supports as shown in the drawing. Plywood supports shall be finished in laminate on it. from both sides & to edges with groove (kani) at corners. The frame shall have 6mm thk. Plywood back & it should be finished with laminate. The desk shall have 12mm. thk. Clear glass with plain diamond edge polish & with round corners on front side. 12 thk. Glass shall be fitted with D-brackets on partition & rubber vacuums on plywood supports. The desk shall have 8mm. thk. Clear glass with plain diamond edge polish from all four sides. This glass should be fitted on D-brackets. The writing desk will be of hanging type as shown in the drawing. The rate should be fitted on D-brackets. The writing desk will be of hanging type as shown in the drawing.				
17	<b>Main Entrance Door with Partition for Branch, ATM</b>	Sft	150.00		
	Providing & fixing main door & partition made up of 12 mm thk. Clear toughened glass shall be fixed in.Ozon / Enox make patch fitting with necessary hardware.With application of sealant from all sides. Edge polish for all exposed sides of glass. Complete as per design Door size 7'0" x 3'0" - Providing & fixing main door made up of 12 mm thk. Clear toughen glass shall be fixed in.Ozon / Enox make patch fitting with necessary hardware like floor spring, 12" S.S. finished decorative handle pair,& locking arrangement. Edge polish for all exposed sides of glass. Complete with bank logo stickers as per design for branch.				
18	<b>Suggestion Box</b>	Nos	2.00		

**CANARA BANK, GA SECTION, CIRCLE OFFICE, HYDERABAD**

	Providing & fixing box made up 19 mm. thk. plywood framework, 6/12 mm. thk. plywood back as required as per design. Good quality blackboard shutters should be fixed on brass hinges should be finished with 1.0 mm. thk. laminate from external side & all un exposed surfaces shall be provided with 0.8mm thk laminate. All exposed edges of plywood should have lipping patti on it. Lipping patti should be finished with French polish on it. The cost should include necessary handles, magnetic catches, Godrej make locks etc. complete as per design.				
19	<b>Cheque Drop Box</b>	Nos	2.00		
	Providing & fixing box made up 19 mm. thk. plywood framework, 6/12 mm. thk. plywood back as required as per design. Good quality blackboard shutters should be fixed on brass hinges should be finished with 1.0 mm. thk. laminate from external side & all un exposed surfaces shall be provided with 0.8mm thk laminate. All exposed edges of plywood should have lipping patti on it. Lipping patti should be finished with French polish on it. The cost should include necessary handles, magnetic catches, Godrej make locks etc. complete as per design.				
20	<b>PILLAR PANELLING / WALL PANELLING</b>	Sft	1,250.00		
	Fabricating and fixing wall/column paneling to consist of Aluminum section Framework of 2" x 1" x 1.5MM Thickness at spacing not exceeding 600mm bothways (horizontal and vertical). Paneling framework to be secured to wall surface/column surface. Paneling framework to be clad on one side with 9mm thick ply finished with 1.0mm thk laminate including skirting of 100mm high & 12mm x 12mm groove at skirting level. Plywood wherever mentioned Must be BWP GRADE AND IS 303, MARKED ISI.(THIS ITEM IS AS PER SITE CONDITION AND AS PER THE REQUIRMENT ) for BRANCH				
21	<b>SHUTTER BOXING - ACP PANELLING</b> OUT OF SHUTTER BOX Supply installation and fixing of ACP cladding with side pillars and front at the entrance to be cladded with standard approved bank colour and ACP to be done one aluminum frames to be made as per the standard specifications and design given by the Bank.	Sft	150.0		

**CANARA BANK, GA SECTION, CIRCLE OFFICE, HYDERABAD**

22	<p><b>FLAP GATE:</b> Providing &amp; fixing in position Flap Gate of different sizes made out of 19mm thick plywood with 1mm thick laminate on both sides of using approved shade &amp; make. Edges are to be provided with beech wood beeding with wood polish. The cost is inclusive of all materials, labour, hinges, etc. The flap gate to be fixed to one side of the adjacent counter using 3" SS butt hinges (75x47x1.70 mm), 1 No oxidized mild steel tower bolt (barrel type) 100x10 mm, magnetic catcher triple strip (vertical type) for the shutter.</p>	No	1.0		
23	<p><b>ROLLER BLINDS</b> Providing and fixing Roller blinds of 100mm of vista Lavour of approved shade/Zebra And pattern as suggested by the bank. The rate shall include necessary scoch gurd treatment on both sides. The overlapping should be uniform and adequate. Necessary operative arrangements, frames to be provided. The work to be completed as per specification and approval of the Bank. MAKE(vista) at banking hall and cabins windows.</p>	Sft	80.00		
24	<p><b>SOFT BOARD:-</b> Providing and fixing soft board with necessary framework with 12mm plywood on top 12 jolly board to be fixed finished with fabric @Rs120 , with necessary mouldings duly polished along the periphery.</p>	Sft	16.00		
25	<p>Aluminium Grill with white/ivory powder coating for Cash cabin top - Providing &amp; Fixing of Aluminium Grills Glazed at Cash Counter. Made out of 2" x 2" hollow square frame section as directed. Work includes antirust coat &amp; two coats of first quality enamel paint. All necessary Items, all taxes, Labour charges, etc., complete for finished of work in all respects.</p>	Sft	50.00		
26	<p><b>DINING PLATFORM</b> Providing &amp; Fixing Dining Platform 2'-0" wide made with 19mm ply finished with 1mm thick laminate on all surfaces including verticals. The platform should be supported on 19mm tk ply verticals placed at 2'0" intervals. All the edges of the plywood are covered with 12mm tk. steam beech beeding duly painted.</p>	Rft	10.00		
27	<p><b>PAINTING (Banking hall)</b> Providing &amp; applying Luster Paint on walls, columns &amp; ceilings. The rate shall include scrapping, levelling &amp; preparing the surface. Primer coat + (minimum) 3 coats to get evenly spread quality finish (roller finish) of approved make, quality &amp; shade shall be provided.</p>	Sft	1600.00		

**CANARA BANK, GA SECTION, CIRCLE OFFICE, HYDERABAD**

28	<b>SYNTHETIC ENAMEL PAINT FOR WINDOW GRILL, ROLLING SHUTTER &amp; COLLAPSEABLE GATE</b> Providing and applying 2 coats synthetic enamel paint on window grill, rolling shutter and collapsible gate. Before putting final paint scrapping, leveling, preparing the surface and 2 coats primer to be done. The wall to be completed as per the direction of Bank.	Sft	380.00		
<b>Total</b>					
<b>Discount</b>					
<b>Total Amount For Interior Furnishing Work</b>					
<b>Final Amount in words: _____</b>					

Note: Entire tender document is to be printed and rates are to be filled by pen. Any tender submitted by copying the contents of this document shall be summarily rejected.

SIGNATURE OF THE TENDERER

