

OPTION - 04



TACTILE POSITION
TILE/BLOCK WITH RAISED
DOTS OF NOMINAL 23mm
DIAMETER AT BASE



TACTILE
DIRECTIONAL
TILE/BLOCK

CARPET AREA : 1060.00 Sq.Ft.
BANKING HALL : 420.00 Sq.Ft.
CUSTOMER LOBBY : 205.00 Sq.Ft.

GENERAL NOTES:-

THIS DRAWING IS THE PROPERTY OF ARCH DESIGN ARCHITECTS AND IS NOT TO BE USED FOR ANY PURPOSE WITHOUT THE PERMISSION OF ITS PRINCIPALS
THIS DRAWING IS TO BE READ IN CONJUNCTION WITH OTHER RELEVANT ARCHITECTURAL, STRUCTURAL AND OTHER SERVICES/CONSULTANT'S DRAWING. IT SHALL BE THE DEEMED RESPONSIBILITY OF THE CONTRACTOR/FABRICATOR TO BRING IN TO NOTICE OF ARCHITECTS IF ANY DISCREPANCY WITHIN OR BETWEEN THE DRAWINGS AND/OR WITH THE WORK TO BE EXECUTED.
ALL WRITTEN DIMENSIONS ARE TO BE FOLLOWED AND THE DRAWING IS NOT TO BE SCALED.
NOTE: ALL DIMENSION ARE IN FEET UNTIL MENTION IN DWG

PROJECT:-

INTERIOR FURNISHING WORK
OF CANARA BANK
RAJNAGAR EXT.
GHAZIABAD

DRAWING TITLE:-

INTERIOR AREA LAYOUT
PLAN FOR GROUND FLOOR

SCALE: N.T.S.

DWG. NO.: ADA-CH-RJF-01

DATE: 04.10.2024



ARCH DESIGN ARCHITECTS
ARCHITECTS, INTERIOR DESIGNER, PROJECT MANAGEMENT
H.O.: C-32, MASAROVER PARK, NEW DELHI-32 B O - GANPATI NIVAS,
CIVIL LINES, BULANDSHAHAR-201002 (MOB: 9869272440, 9812857666,
Email: archdesignraj@gmail.com)

Security clearance to be ensured. Ramp @ 1:12 to be ensured for Bheel / ATM Entrance

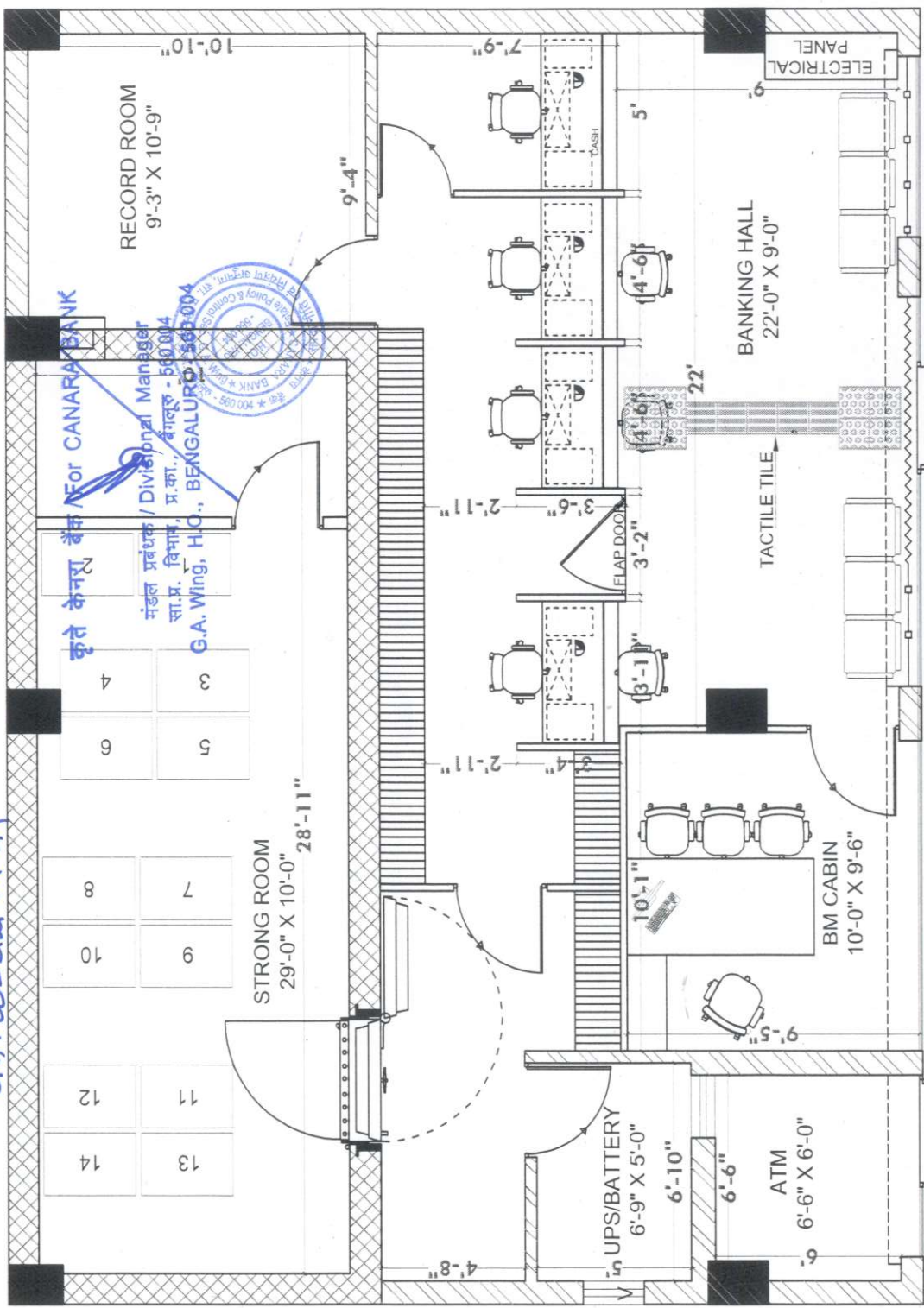

Wash Rooms are Common as per GA: Code of Mani

कुते केनरा बैंक For CANARA BANK
मंडल प्रबंधक / Divisional Manager
स.प्र. विभाग, प्र.क. गालूर - 560004
G.A. Wing, H.O., BENGALURU - 560004

Layout is Approved Subject to compliance of observations made vide Ref. No. 69/2024-25 Date: 05/10/2024

Internal