

Sym.	Description
	5 A - 5 Pin Ele out let
	15/20 A 6 Pin Ele out let
	5 A Switch & 5A Socket
	20W Led Tube light
	Led bulb as per BOQ
	18 W Recesses mounted Down light as per BOQ
	2x2' 36W LED Panel Light as per BOQ
	15" Ø Exhaust fan as per BOQ with 5A socket
	400MM Ø Wall Mounted fan as per BOQ with 5A socket
	AC Point
	Distribution board
	Meter panel with bus bar

- (2x2.5+1x1.5) Sqmm P.V.C Insulated copper conductor cable for circuit wiring.
- (2x4+1x1.5) Sqmm P.V.C Insulated copper conductor cable for AC circuit wiring
- (2x1.5) Sqmm P.V.C Insulated copper conductor cable for point wiring.

ELECTRICAL ROOF LAY OUT	
CANARA BANK SERAIKELLA BRANCH	
Ref No-EI/Ser/24-25	
Date-29/07/2024	

M/S RAM LAKSHMAN & SRY ASSOCIATE  
Architect, Interior designer & Valuer  
Flat No-101, Beta Block , Shree residency  
Marin drive road Kadina, Jammehdipur-831005  
Email-yaashwathi16@yahoo.com  
MO-9431832201 ,9203283491

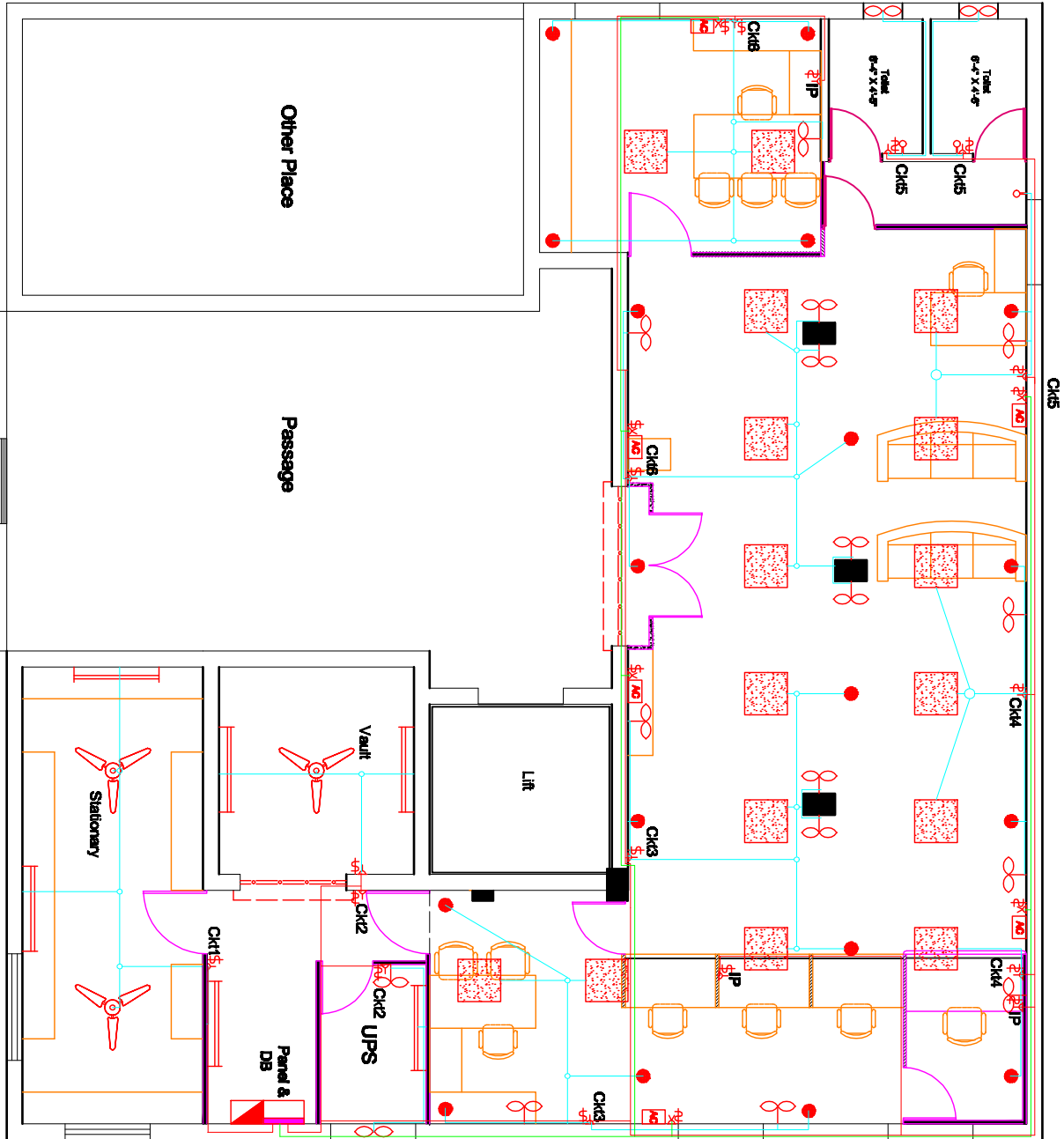

Note-Ckt Indicate number of circuit.Each circuit maximum 10 point connected.  
Note-Maximum 3 circuits wires can be drawn through one 25 mm Dia P.V.C conduit pipe.

Note-Number of circuit may be increase but root cannot be change without approval.  
IP - Indicate Independent Plug point for Pisher/Cash counting