

WHF- (W)
TL- T-

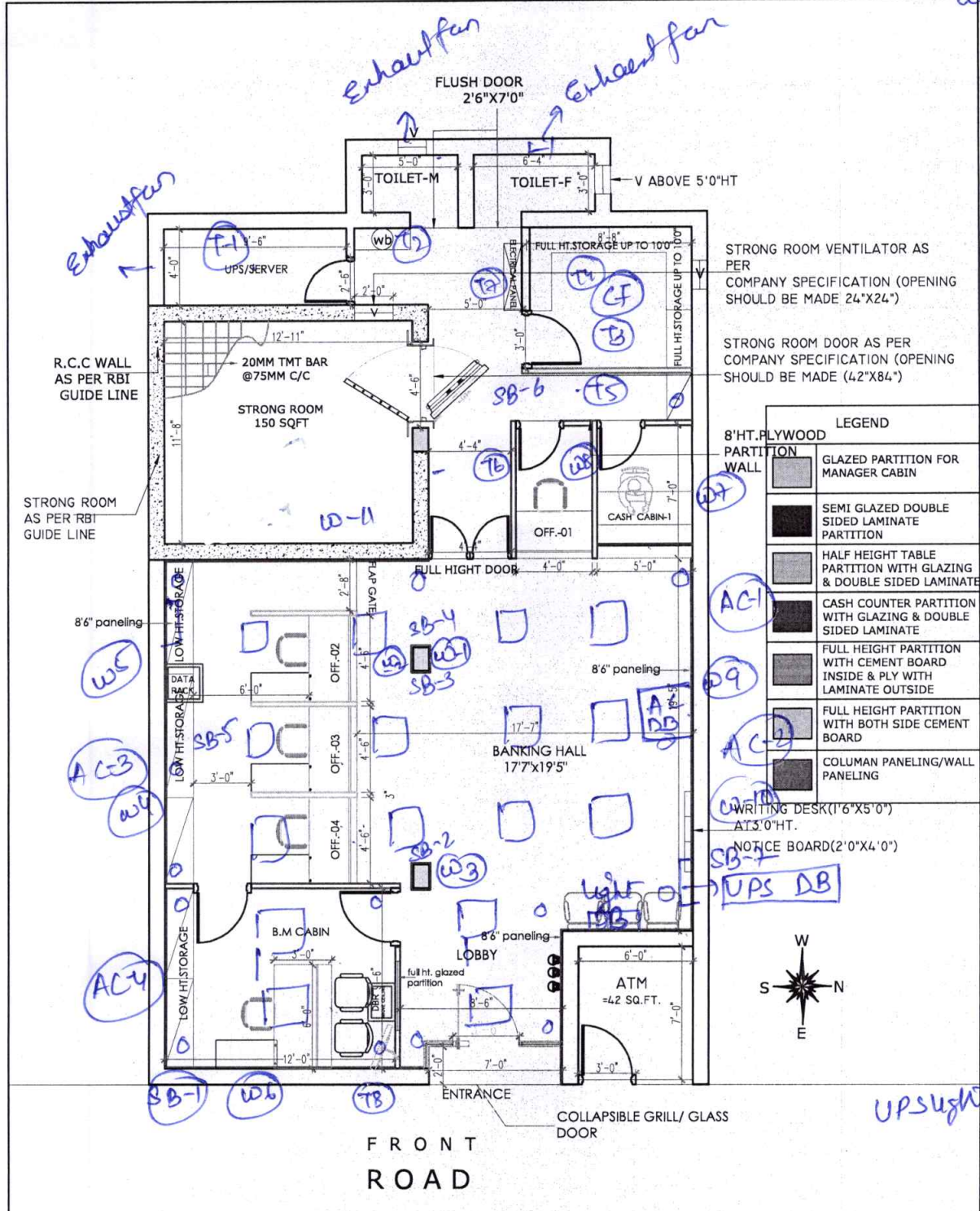

STRONG ROOM VENTILATOR AS PER COMPANY SPECIFICATION (OPENING SHOULD BE MADE 24"x24")
STRONG ROOM DOOR AS PER COMPANY SPECIFICATION (OPENING SHOULD BE MADE (42"x84")

LEGEND	
8'HT.PLYWOOD PARTITION WALL	GLAZED PARTITION FOR MANAGER CABIN
	SEMI GLAZED DOUBLE SIDED LAMINATE PARTITION
	HALF HEIGHT TABLE PARTITION WITH GLAZING & DOUBLE SIDED LAMINATE
	CASH COUNTER PARTITION WITH GLAZING & DOUBLE SIDED LAMINATE
	FULL HEIGHT PARTITION WITH CEMENT BOARD INSIDE & PLY WITH LAMINATE OUTSIDE
	FULL HEIGHT PARTITION WITH BOTH SIDE CEMENT BOARD
	COLUMNAN PANELING/WALL PANELING

WRITING DESK(1'6"x5'0") AT 3'0"HT.
NOTICE BOARD(2'0"x4'0")
UPS DB



UPSIGHTS - MC-1no.
Cash-1no.
Customer-1no.

CARPET AREA CALCULATION-1201+76+19=
1296-4 SQFT(COLUMN)
=1292 SQFT

OPTION-01

Notes : ALL DIMENSIONS ARE TO BE CHECKED AND CORRELATED WITH THE RELEVANT ARCHITECTURAL & STRUCTURAL DRAWINGS AND ANY AMBIGUITY SHALL BE IMMEDIATELY BROUGHT TO THE NOTICE OF THE ARCHITECTS BEFORE COMMENCEMENT OF THE WORK. THIS DRAWING IS THE PROPERTY OF ATTIK ARCHITECTS AND IS NOT TO BE COPIED OR USED WITHOUT THEIR PERMISSION.	Architects : ATTIK ARCHITECTS Architects SITHLA ASTHAN ROAD, NEAR TILAKMANGI THAKA, BHAGALPUR, JH. NO. 7503821328 9430546484, 9899677289	Drawing Title:- PETARBAR BRANCH	REVISIONS: No. Date Description	Date:- 06-03-2025	Checked by: AR,VIKASH KR.	NORTH:
	Consultants :	Client : CANARA BANK	Job Title :	Scale:- NTS	Dealt by:	R 1
ATTIK ARCHITECTS						

RJ-45 - Cash cabin - 2no.
Off-1, 2, 3, 4 - 4no.
BM cabin - 2no.
Hall - 1no.
ATM - 2no.

Independent - AC - 4no.
Cash - 1no.
Off-1 - 1no.
Off-3 - 1no.
BM cabin - 1no.
DR - 1no.
+ extra FR, DB, CCTV - 3no.

Compartments - Cash - 2no.
Off-1 - 1no.
Off-2 - 1no.
Off-3 - 1no.
Off-4 - 1no.
BM - 2no.
Data - 1no.
Hall - 1no.

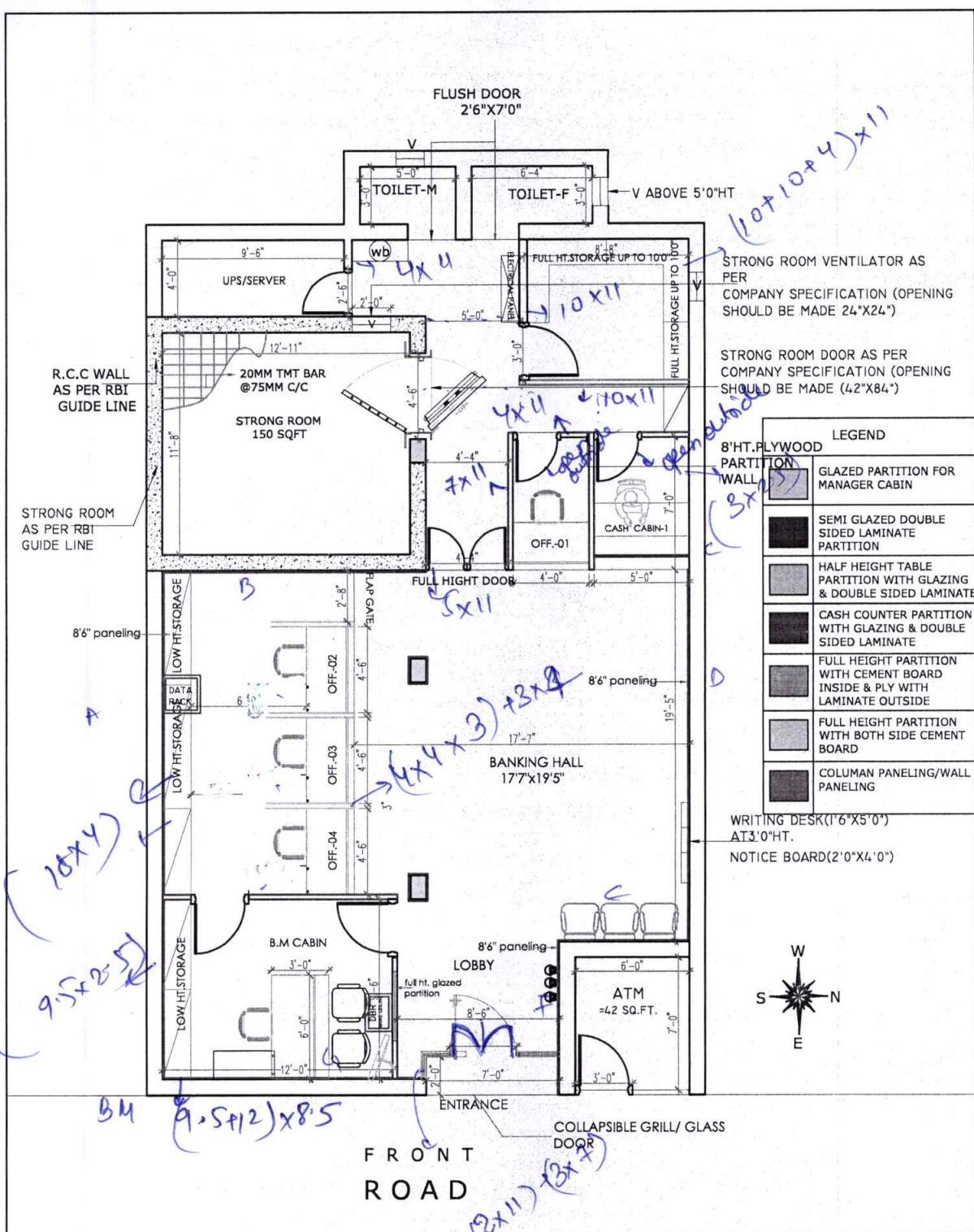

Handwritten notes on the left side of the plan:

- (10x4)
- (9.5x8.5)
- B4
- (9.5+12)x8.5

Handwritten notes on the right side of the plan:

- (10+10+4)x11
- 10x11
- 4x4
- 7x11
- 5x11
- (4x4x3)+8x4
- (2x11)+8x4

Handwritten calculations on the far right:

- 20x20 = 784
- 15x11 = 165

CARPET AREA CALCULATION-1201+76+19=
1296-4 SQFT(COLUMN)
=1292 SQFT

OPTION-01

Notes : ALL DIMENSIONS ARE TO BE CHECKED AND CO-RELATED WITH THE RELEVANT ARCHITECTURAL & STRUCTURAL DRAWINGS AND ANY AMBIGUITY SHALL BE IMMEDIATELY BROUGHT TO THE NOTICE OF THE ARCHITECTS BEFORE COMMENCEMENT OF THE WORK. THIS DRAWING IS THE PROPERTY OF ATTIK ARCHITECTS AND IS NOT TO BE COPIED OR USED WITHOUT THEIR PERMISSION.	Architects : ATTIK ARCHITECTS architect 5TH FLOOR, ASTHAN ROAD, NEAR TILAKA NAGRI THANA, BHAGALPUR, JH. NO. 7503821328 943546484, 9899677289	Drawing Title:- PETARBAR BRANCH	REVISIONS: <table border="1"> <tr><th>NO.</th><th>DATE</th><th>BY</th><th>REASON</th></tr> <tr><td> </td><td> </td><td> </td><td> </td></tr> <tr><td> </td><td> </td><td> </td><td> </td></tr> <tr><td> </td><td> </td><td> </td><td> </td></tr> </table>	NO.	DATE	BY	REASON													Date:- 06-03-2025 Scale:- NTS	Checked by: AR.VIKASH KR. Dealt by:	NO.HT : R 1
	NO.	DATE	BY	REASON																		
Consultants :	Client : CANARA BANK	Job Title :	ATTIK ARCHITECTS <small>This drawing is the property of Attik Architects. As part of this service, the Architect is responsible for the design and preparation of working drawings. The Architect shall not be held responsible for any errors or omissions in the drawings and shall not be liable for any consequences arising therefrom.</small>																			

Handwritten calculation at the bottom:

Panelly - 20 x 8.5 + 15 x 8.5 + 20 x 8.5 + 8 x 8.5 + 9 x 8.5 + 14 x 8.5 + (7 x 8.5) x 2 = 54 x 8.5