

PROJECT
 MODIFIED BANK BUILDING
 LAYOUT PLAN OF THE
 "CANARA BANK"
 BRANCH - RAH
 HARDWAR

OPTION :-15
 DATE :- 03 DEC..2024 - TUESDAY
 SPACE FOR OFFICE USED:-

DETAIL OF AREA CHART	IN SQ.FTS.
CARPET AREA FOR HALL	2241.28
TOTAL CARPET AREA	2241.28
CARPET AREA OF TOILETS (NOT COUNTING IN CARPET AREA)	0118.79

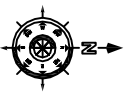

CANARA BANK

FLOOR NO. - FIRST FLOOR
 EXISTING HEIGHT WITH/OUT SLAB:-
 UP TO BEAM 10'-00"
 FULL HEIGHT 11'-00"
 ANY INQUIRY / INFORMATION
 CONTACT TO:- E. ABDUL MANNAN
 MOB:09997/339956, 09837933338



A.MANMJEET SINGH BALAJI
 ARCHITECT, ENGINEERING CONSULTANT & VALUERS
 10/117, 1ST FLOOR, MAIN MARKET, NEAR
 TEL: 0182-2531121, 2531122, 2531123
 MOB: 9810022800, 9810022801
 E: a.manmjeet@balaji.com

CORPORATE OFFICE :- B-24 GROUND FLOOR
 402- 333 12A, DEERVAAN-2800 CLUSTER
 NEAR INDRAKUMAR BAMP,
 TARSOLI
 402- 333 12A, DEERVAAN-2800 CLUSTER
 NEAR INDRAKUMAR BAMP,
 TARSOLI
 D:\M\ Workshop\Balaji

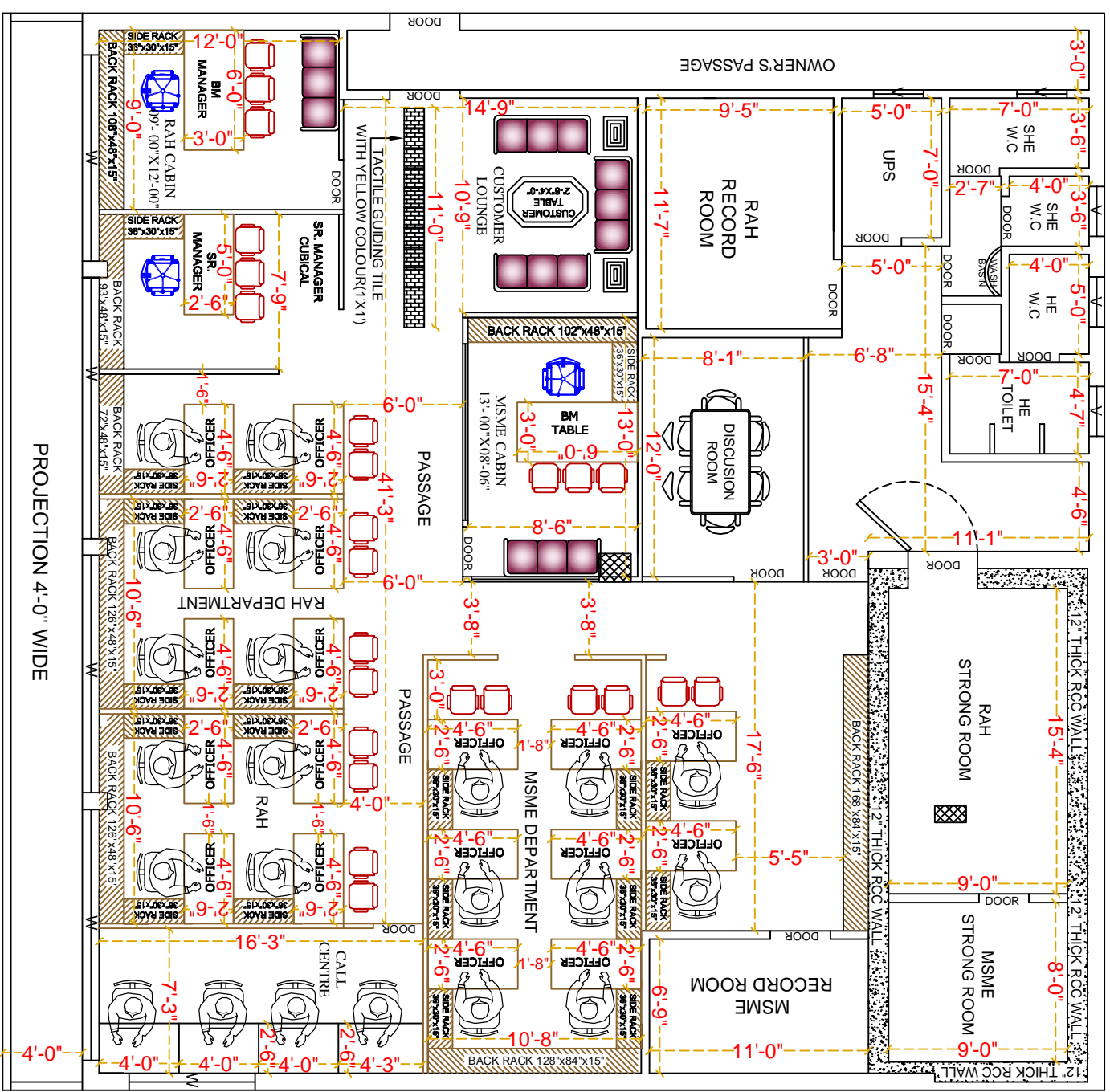

PROJECTION 4'-0" WIDE