

THIS DRAWING IS THE PROPERTY OF NARENDRA SARDESHPANDI & ASSOCIATES AND ITS USE IN ANY MANNER BY ANY PERSON WITHOUT PERMISSION IS PROHIBITED.

- NOTES :-**
1. ALL LEVELS ARE FINISHED FLOOR LEVELS UNLESS OTHERWISE MENTIONED.
 2. THE ARCHITECTURAL WORKING DRAWINGS MUST BE COORDINATED WITH THE RELEVANT DRAWING FROM OTHER CONSULTANTS BEFORE EXECUTION. ANY DISCREPANCY MUST BE BROUGHT TO THE NOTICE OF THE ARCHITECT IMMEDIATELY.

LEGEND CIVIL ALTERATIONS

SYMBOL	DESCRIPTION
	PROPOSED BRICK WORK
	WALL TO BE DIMOLISH
	P.O.P. PUNNING ON WALL
	PLASTER ON WALL

CARPET AREA

OCCUPANCY TABLE

SR NO	DESCRIPTION	OCCUPANCY	
		REQUIRED	PROVIDED
1.			
2.			
3.			
4.			
5.			
6.			

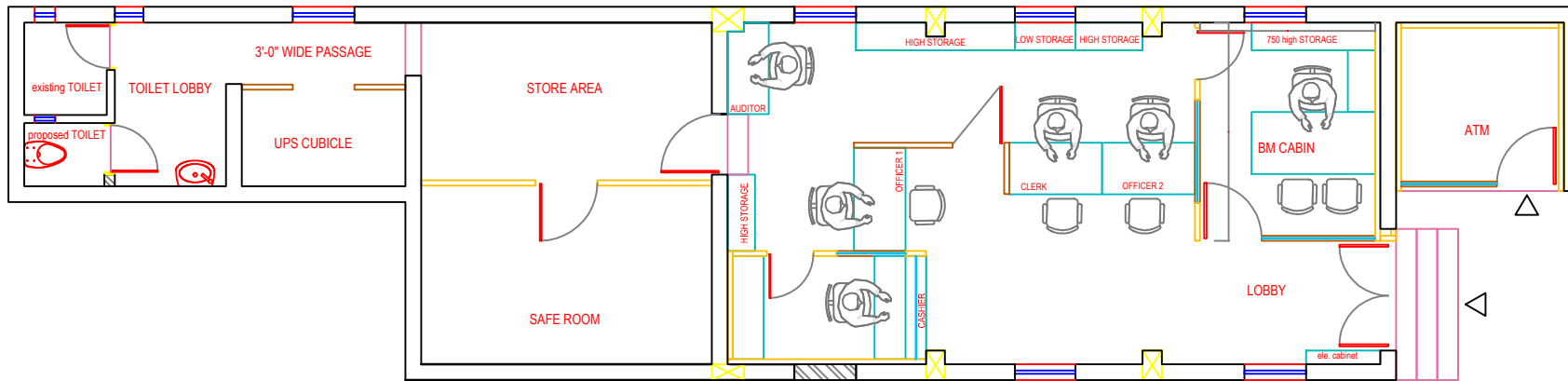

PROJECT :- PROPOSED INTERIOR DESIGN OF KARANJI BRANCH

CLIENT:- CANARA BANK

SITE :- KARANJI, DIST. AHMEDNAGAR



NARENDRA SARDESHPANDI & ASSOCIATES
Architects

41, "Sardar", Plot No. 2, Ground Floor, Sahel Station Road,
Bhilai, West Chhatisgarh State, Madhya Pradesh-492001
Tel:- 0992 2842 42 07, E-mail: nsai@nsai.com

DRAWING CATEGORY SHEET

SCHEME DRAWING

SD (A) 01 SCALE 1:75

JOB NO. DATE DRAWN BY REVISED BY

223-36 08.05.24 YOGI RAJ

