

OPTION - 03A

Layout is Approved Subject to
compliance of observations made vide
Ref. No. 40/24-25
Date: 12/4/24

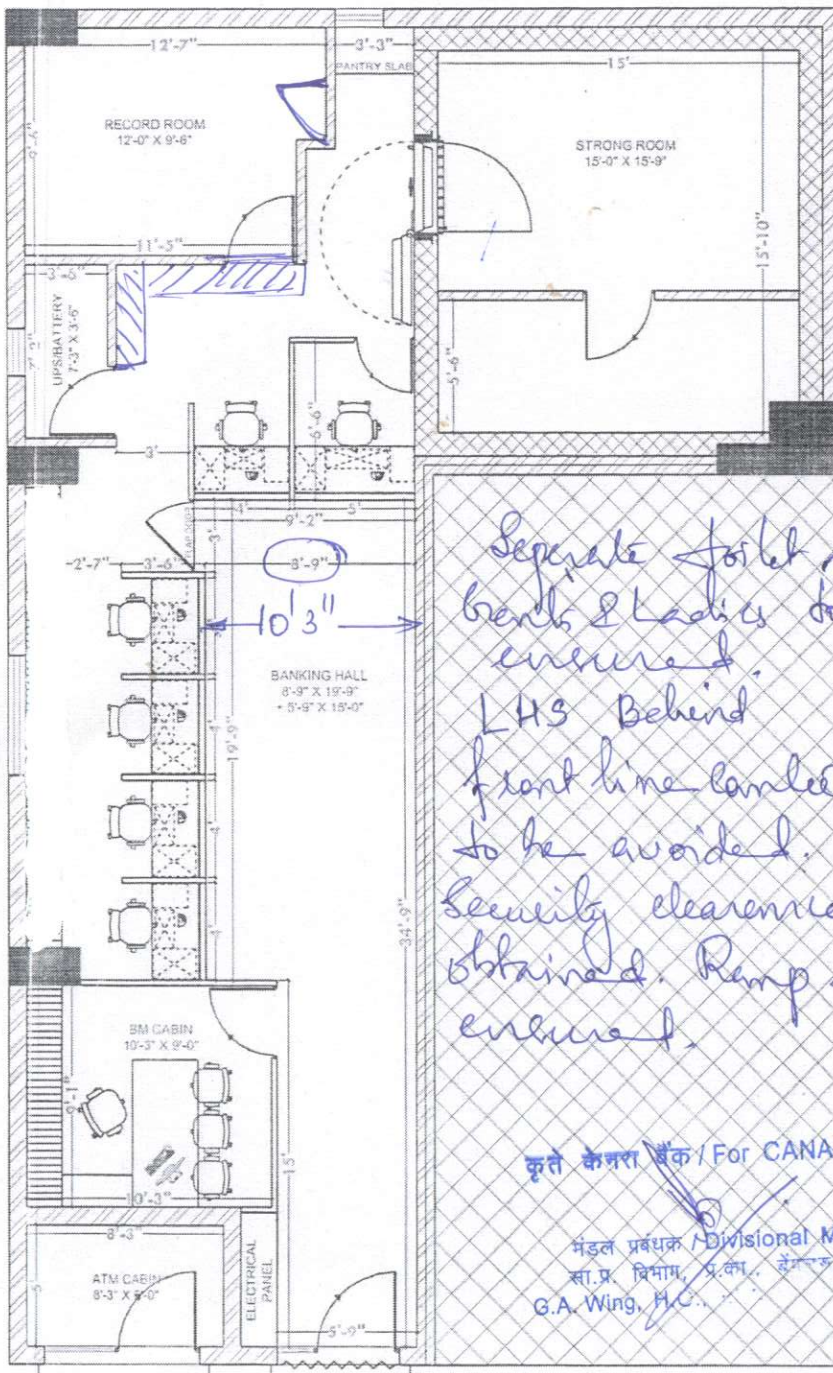

AREA STATEMENT

CARPET AREA = 1100 SQ.FT.

BUILTUP AREA = 1300 SQ.FT.
(INCLUDING OUTER WALL)

GENERAL NOTES:-

THIS DRAWING IS THE PROPERTY OF ARCH DESIGN ARCHITECTS AND IS NOT TO BE USED FOR ANY PURPOSE OTHER THAN FOR WHICH IT IS ISSUED WITH OUT PERMISSION OF ITS PRINCIPALS.

THIS DRAWING IS TO BE READ IN CONJUNCTION WITH OTHER RELEVANT ARCHITECTURAL, STRUCTURAL AND OTHER SERVICES/ CONSULTANTS DRAWING. IT SHALL BE THE DEEMED RESPONSIBILITY OF THE CONTRACTOR/ FABRICATOR TO BRING IN TO NOTICE OF ARCHITECTS IF ANY DISCREPANCY WITHIN OR BETWEEN THE DRAWINGS PRIOR TO CONSTRUCTION.

ALL WRITTEN DIMENSIONS ARE TO BE FOLLOWED AND THE DRAWING IS NOT TO BE SCALED.

NOTE- ALL DIMENSION ARE IN FEET UNTIL MENTION IN DWG

DRAWING TITLE:-

PROPOSED INTERIOR LAYOUT PLAN
FOR CANARA BANK AT
GAUR CITY @ GAUR CHOWK
GREATER NOIDA

PROJECT:-

INTERIOR LAYOUT PLAN
FOR GROUND FLOOR

SCALE:-

N.T.S.

DWG. NO.:-

ADA-CB-GYC-01

DATE:-

15.04.2024

NORTH:-



कृते केनरा बैंक / For CANARA BANK

मंडल प्रबंधक / Divisional Manager
सा.प्र. विभाग, प्र.का., हैदराबाद 580 004
G.A. Wing, H.C.

GROUND FLOOR PLAN



ARCH DESIGN
ARCHITECTS

