

FURNISHING WORKS IN NEW & EXISTING PREMISES OF BAGALKOT RO

Location of the Branch/Office	CANARA BANK RO BAGALKOT
Eligibility of the contractor	Eligible Furnishing Contractors Empaneled with Circle Office: Hubballi
EMD	₹ 75,000/- Exemption Permitted under MSME Scheme on submission of relevant documents.
Address for submission of sealed tenders	Circle Office: Hubballi
Last date & time for submission of sealed tenders	06.01.2025 up to 3:00 pm
Date & Time of opening of sealed tenders	06.01.2025 up to 3:30 pm
Payment terms	As per IBA norms.
Time limit for execution of work	45 days from the date of work order
Defect liability period	12 months after completion of work
Retention money towards defect liability period	3 % of final bill amount
Date of commencement of work	As per work order
Income Tax &/ other taxes	At applicable rate
Payment	After the completion of the work, as per procedure
Period for submitting final bill by contractor	Within one month from the date of virtual completion of the work
Liquidated damage for non-completion of work in time	1% OF THE TENDERED AMOUNT per week and part thereof for the delayed period maximum of 5%.
Rates quoted by bidder	I. The quoted rate should be inclusive of Cost of materials, transport, loading , unloading charges, cost of installation, all taxes (excluding GST) , wastages, machinery, temporary works such as scaffolding, cleaning, overheads, profit, statutory expenses, incidental charges and all related expenses required for the completion of the work. II. Additional claims other than the quoted amount will not be entertained. III. The quoted rates shall be firm throughout the completion of the project
Insurance	Falls under scope of contractor.
Validity of submitted tender	90 days from the opening of tenders

The sealed tender must be dropped in tender box kept at the Circle Office within the above stipulated time. Tenderer / authorized representative are requested to be present at the time of opening. Canara Bank will not be bound to accept the lowest tender & reserves the right to reject any or all the tenders without assigning any reason thereof.

NIT Ref. COHUB: P&E:DPJ:6925:49: 2024-25 dated 26.12.2024

To
The Assistant General Manager,
P & E Section,
Canara Bank Circle Office,
Hubballi - 580030.

Dear Sir,

Sub: Furnishing works in the premises of RO Bagalkot.

I/We hereby declare that I/ We have carefully gone through the conditions laid down in the Notice Inviting Tender, General notes, General Conditions of Contract, Special conditions, Schedule of approximate quantities and rates, Form of Agreement, General Specification, Approved manufacturers/natural source of materials Technical Specifications of schedule of quantities, and clearly understood all the same and on the basis of the same I/ We have quoted our rates in the Schedule of Quantities(i.e. BOQ) attached with the tender documents.

I / We have enclosed herewith a Demand Draft of _____Bank & No. _____ dated _____ favoring **Premises & Estate Section, Circle Office, Canara Bank, Hubballi** for ₹ _____ payable at Hubballi, towards E.M.D.

In the event of this Tender being accepted I/ We agree to enter into the agreement and submit the declaration on requisite non-judicial stamp papers as and when required and execute the contract according to your form of Agreement etc., in default whereof, I/ We do hereby bind my-self / ourselves to forfeit the aforesaid deposit.

I / We further agree to complete the work included in the said schedule of quantities within specified time from the date of the work order issued to commence the same.

I / We agree to pay all taxes(except GST), insurance charges as prevailing from time to time, on such items for whom same is to be levied by/ for the government, and the rates quoted by me / us are inclusive of all the same.

Once again knowing full well the contents of this tender, I / We sign this tender on this _____Day of _____ month of 2023.

Signature of the Contractor with seal & date

SPECIAL CONDITIONS & INSTRUCTIONS FOR THE GUIDANCE OF TENDERER

1. The works at the branch/Office premises need to be executed duly taking care of the local bye laws/regulations of the local authorities like Police Dept, Water supply and Sanitary Board, Electricity Board, Central/ State Labor Commission etc. Necessary permissions, licenses, temporary connections if needed shall be obtained by the Contractor and Bank shall not be held responsible for any lapses.
2. The works shall be executed duly taking care of all safety measures and Bank shall be fully indemnified for any 3rd party claims, casualties, mishaps, loss of property etc. related to the undertaking & the execution of the subject work.
3. GST TAXES: As per the new Goods & Services Tax (GST) structure, the tenderer are required to have GSTIN number & Tenderer without GSTIN number are not eligible to participate in the tender process. The details as per the Annexure I attached are to be mandatorily furnished along with the tender. The eligible tenderer are requested to quote the GST separately. The taxes will be deducted at source as per the statutory requirements. While raising the bill, it shall be mentioned as bill to Canara Bank and our Bank's GSTIN number to be mentioned.
4. CANARA BANK'S KARNATAKA STATE GSTIN NUMBER is 29AAACC6106GIZX.
5. Tenderer are requested to submit the EMD in the form of crossed Demand draft only on any of the nationalized Banks/State Bank Drawn in favor of Premises & Estate Section, Circle Office, Canara Bank, Hubballi, payable at Hubballi. Tender with EMD in any other forms shall be rejected.
6. Tenderer are expected to visit the site before quoting the rates and should satisfy themselves as to the nature and conditions of work facilities available etc.
7. The tenderer are required to examine the enclosed general plan, tender form and conditions mentioned in the tender.
8. The tenderer should quote the rates in the figures. The amount for each item should be worked out and the requisite totals shall be given. The total amount shall be written both in figures and words.
9. The rates quoted in the tender shall be for measured finished works and shall include all changes including cost of materials, transportation, freight charges etc. complete.
10. The work is to be completed within stipulated time.
11. The successful tenderer shall give all necessary personal attention to the work during the process of work and also until the expiry date of "Defects Liability Periods" which is 12 months after the date of completion of the work.
12. The bank reserves the right to reject any portion of the work or material, which is, found unsatisfactory not up to the standard.
13. A retention amount of 3% of the bill amount will be retained from the final bill and shall be paid to the successful tenderer after the defects liability period is over and upon the certification of the engineer.

NIT Ref. COHUB: P&E:DPJ:6925:49: 2024-25 dated 26.12.2024

14. Income tax deduction at prevailing / appropriate rates will be retained from each running bill which will be certified by the income tax authorities and a receipt will be given to the contractors.

CONDITIONS OF CONTRACT

1. If any additions and alterations are found necessary, the tenderer will have to do the same within the tendered rates with the prior approval of the bank.
2. The contractor shall employ adequate labor to complete the work within the scheduled time and shall make his own arrangements for housing his materials etc.
3. The contractor shall have to make his own arrangements to house his labor and staff for their services.
4. All tendered rates shall include for the cost of materials, labor, supervision, tools, plant, transportation, contingencies, duties, breakages, wastages, sundries, scaffolding, etc complete.
5. All instruction regarding the execution of the work shall be received from the officials through consultant/architect only. Any other instructions issued directly to the contractor by anyone else shall not be binding on the bank.
6. The bank shall have the power to omit or cancel any item of work without assigning any reason whatsoever and no claim for compensation for damage will be entertained for such omissions and cancellation.
7. The contractor shall maintain satisfactory progress of work as well as maintain a desired level of workmanship. If in the opinion of the bank the progress is unsatisfactory and / or the workmanship is unsatisfactory then the bank shall take possession of the work within 7 days to that effect. The bank shall then complete the entire work and rectify all the defects at the contractor's cost and consequences.
8. In case the bank is not satisfied with the quality of materials used by the contractors, they reserve the right to direct the contractor to procure such materials supplied from agencies they deem fit.
9. The contractor is to be responsible for clearing any, all dirt and rubbish and superfluous materials as they accumulate and everything unnecessary and to leave the premises in a clean and orderly condition on completion and fit for occupation. No extra payment shall be made for doing this.
10. Any work which is not approved by the bank shall have to be removed within 24 hours from the time of order and shall have to be redone by the contractor at his own cost and this cost will be borne by the contractor.
11. No deviation whatsoever for any reason will be permitted, however, if any deviation becomes necessary, the same should be brought to the immediate notice of the bank and written approval must be obtained for such deviation before proceeding with the execution of work.
12. The bank has got the right to supply any materials required for the work and cost of materials so supplied will be deducted from the bills of the successful contractor.

NIT Ref. **COHUB: P&E:DPJ:6925:49: 2024-25 dated 26.12.2024**

13. The contactor shall be responsible for safe custody of his materials/materials issued to him by the bank till they are used for the work. He shall make his own arrangements for the safe custody and proper storage and preservation in sound condition till the same are actually used in the work.
14. The tenderer shall extended full co-operation to the other contactor /agencies like electrical, air conditioning, Fire & CCTV, LAN etc who are also working for the same project and co-ordinate with them in finishing the awarded work within the stipulated time given.
15. The contactor shall have a competent supervisor on the site for all the time.
16. For any new item the rate will be fixed by the bank as per prevailing fair market rate and labor which will be binding on the contactor.
17. In case the brand of materials mentioned in the tender is not available in the market, the alternate brand shall be used only after prior written approval of the bank.
18. The contactor shall be given a single electrical connection at work site. Electrical charges for consumption by the contactor will be charged separately by the bank, contractors have to provide sub-meter.
19. The successful tenderer shall not anticipate any financial help from the bank in the form of adhoc payment / advance for mobilizing and for starting the work.
20. The contractor should strictly adhere to the specifications and make of the materials, mentioned in the annexure. Any deviation will summarily reject the items of the work and not qualify for payment.
21. The successful tenderer shall be ready to carry out works between non banking hours and even at nights and holidays. The contractor should sign all the pages of the document and the same shall be submitted to us.

Acceptance of contractor for Labor laws

- The successful tenderer / Contractor shall carefully and diligently implement the provisions of the Contract Labor Act & Contract Labor Rules.
- The Bank shall be entitled to deduct from the Contract Consideration, any such amount which the Bank has to pay in accordance with the Contract Labor (Regulation & Abolition) Act 1971 and Workmen's Compensation Act, in the event of the Bank having to disburse compensation / effect any payment under the Contract Labor Acts / Rules.
- Please note that as per rule 81(1) of Contract Labor (R&A) Rules, 1971, it is mandatory on the part of the Contractor to the display the notice containing the following details at prominent place at the work site.
 - a) Rates of wages.
 - b) Hours of work.
 - c) Wage periods.
 - d) Dates of payment of wages.
 - e) Names & addresses of the Labor Inspectors having jurisdiction &
 - f) Date of payment of unpaid wages.

NIT Ref. **COHUB: P&E:DPJ:6925:49: 2024-25 dated 26.12.2024**

The notice containing the above details shall be displayed without fail at the work site.

1. The Contractor shall not engage any workmen for wages, less than the minimum wages prescribed under the notification issued by the Central Government.
2. The contractor should follow all labor laws/guidelines laid down by central /state government from time to time.
3. **ABNORMALLY HIGH AND LOW RATED ITEMS :**

For item rate tenders if, the rates quoted by the lowest bidder for certain items of the Bill of Quantities of the tender are found to be abnormally high or low in comparison to the market rate analysis of the item done by the Architects/Bank and or in comparison to Architect/Bank's method of working out market rate justification for the items, the same shall be governed as under in order to avoid financial loss to the Bank in the event of default of Bidders.

- i. For abnormally high rated items (AHR), the progressive payment shall be 80% (eighty percent) of the payment due to the Bidder against execution of the AHR item. The balance withheld 20% payment shall be released after 75% of total value of the original contract is complete in financial terms or this 20% withheld payment can be released to the Bidder on submission of an unconditional bank guarantee of equivalent amount in the proforma of Bank. Further deviation limit for AHR items shall be nil on plus side and Bank reserves the right to restrict, substitute or not execute the AHR items during execution. The decision of the Architect/Bank's Engineer in this regard shall be final and binding on the Bidder.
- ii. For abnormally low rated (ALR) items the Bidder shall submit Bank Guarantee of difference in total of amount of ALR item(s) and the total amount of corresponding items at market rate of the Architect/Bank. This bank guarantee shall be valid till completion of the project. In exceptional circumstances, the amount of Bank Guarantees (BG) may be reduced or BG released earlier than completion period if, in view of Architect/Bank's Engineer, all ALR items as provided in the contract are executed as per terms of contract and/or not required to be executed.

Notwithstanding what is contained in Para i) & ii) above, the provisions of Para (i) and (ii) shall not be applicable on tenders invited on percentage rate basis.

The decision of the Bank on identification/ marking of AHR and ALR item are final and binding on the Bidder. In case the Bidder do not agree for furnishing of Bank Guarantee as above towards ALR items, at the time of award of works, the EMD/Performance guarantee of the Bidder shall be forfeited and decision of Architect in this regard shall be final and binding on the Bidder.

CERTIFICATE

I / WE HAVE READ, FULLY UNDERSTOOD THE ABOVE-MENTIONED REGULATIONS OF LABOUR LAWS/GUIDELINES AND ACCEPT THE SAME IN TOTO. I ALSO UNDERTAKE TO FOLLOW ALL LABOUR LAWS/GUIDELINES LAID DOWN BY CENTRAL /STATE GOVERNMENT FROM TIME TO TIME & INDEMNIFY THE BANK AUTHORITIES.

ANNEXURE I (TO BE MANDATORILY FURNISHED)

1.	Name of the Contractor under the Contract Labor (Regulation and Abolition) Act, 1970 (37 of 1970) (if applicable)	
2.	LIN / PAN No	
3.	Email Id	
4.	Mobile No.	
5.	No. & date of Certificate of Registration/ License*	
6.	Name of Person in charge of work	
7.	LIN / PAN No. of the person in charge of work	
8.	Email Id of the person in charge of work	
9.	Mobile No. of the person in charge of work	

* Please strike off whichever is not applicable

APPROVED LIST OF MATERIALS

1	Wood: All wood must be well seasoned, free from knots, other defects, decay and defects due to handling and transportation. Wherever necessary provide with anti-termite treatment.	Sal wood/ Thali wood (imported)
2	Teak Wood	Old Burma Teak
3	Marine grade plywood (BWF PF bounded)	ISI marked, complying to BIS specifications UNIPLY/ KITPLY/ CENTURY PLY/ ARCHID PLY
4	MR grade commercial plywood 4mm/6mm/12mm/ 19mm/25mm sizes.	ISI marked, complying to BIS specifications UNIPLY/ KITPLY/ CENTURY PLY/ ARCHID PLY
5	Veneers	Anchor/Green Ply / Century / Euro
6	Laminate: Design , shade, finish as per Architect's Selection confirming to IS: 2046	Decolote- formica/ Marino/ mica Greenlam / Meriono / Euro
7	Powder coated track, ceiling	Interarch, Vista – levotor, Luxalon
8	Hinges, tower bolts, handles	Brass oxidized/ epoxy powder coated (heavy duty)
9	Glass, Float Glass	Saint-Gobain / Modiguard / Asahi
10	Adhesive materials	Fevicol (pidilite make)
11	Powder coated aluminum partitions (15.20 micron two step electrical color process using polyester powder)	Jindal / Indal/ Hindal (Heavy Gauge 1.2 mm th, 15.20 micron 2 Step thick electrical color process Using polyester powder)
12	Pre laminated boards confirming to IS: 12823: 1990	Novopon /Eco board (Exterior grade only)
13	Floor springs confirming to IS: 6315/ door closure confirming to IS: 3564	OZONE/ HAFELE/EBCO
14	Fixtures	All hardware fittings & fixture are to be powder coated. Color, finish as per Bank's specification, Godrej makes.

NIT Ref. COHUB: P&E:DPJ:6925:49: 2024-25 dated 26.12.2024

15	Melamine Polish	Asian Paint / ICI / Nerolac
16	External Emulsion (Anti-flaking, Anti-fungal)	Asian (Ace)/ Nerolac/ Berger/Dulux Sample to be approved by the Architect.
17	Oil Bound Distemper	Asian / Nerolac/Berger/Dulux Sample to be approved by the Architect.
18	Synthetic Enamel Paint	Asian /Nerolac/Berger/Dulux. Sample to be approved by the Architect.
19	Automobile Duco paint	MRF / ICI / Asian
20	Carpet Tiles	Nylon carpet tile -shaw/Milliken/Bentley prince
21	Cement	ACC, UltraTech, Ambuja - 43 grade
22	Bricks	Burnt bricks with minimum strength of 35KG/Cm ²
23	Hinges / drawers	Earl-Bihari Pvt Ltd, Godrej
24	Steel	HYSD bars with FE-415 grade
25	Vitrified tiles	Naveen / RAK / Nitco / Kajaria
26	Ceramic Tiles	H & R Johnson/Bell/Kajaria/Naveen /Spartek.
27	Glazed Tiles	H & R Johnson/Bell/Kajaria /Spartek/ Naveen
28	Tiles fixing adhesive	Algitile / Balgrout.
29	False Ceiling tiles	Armstrong or equivalent only
30	Italian Marble	Classic / Nitco / Elegance
31	Vertical / roller blinds	Hunter Douglas, Mac, Vista, Technifab
32	Wall paper	Marshall / ego / softek
33	Glass film	GARWARE OR EQUIVALENT
34	Drawers / cupboards Locks	Godrej / Yale / Hafele / Dorma Laxmi Make
35	Door Locks	SS finished Mortise lock of Laxmi make
36	PVC Pipes	Finolex /Prince
37	M.S.Pipes	Tata
38	Sanitary Ware	Parry ware /Hindustan sanitary
39	Granite slab 20 mm thick	Edges shall be rounded. Beveled.
40	Vinyl flooring (2mm thick)	Royal House
41	Door closure	Everite/ Godrej/ Hafele
42	Steel	Kamadhenu

Note: Samples are to be approved by Bank and Architect if any. Any brands indicated under the items specifications in the Bill of quantities will prevail over the above indicated makes.

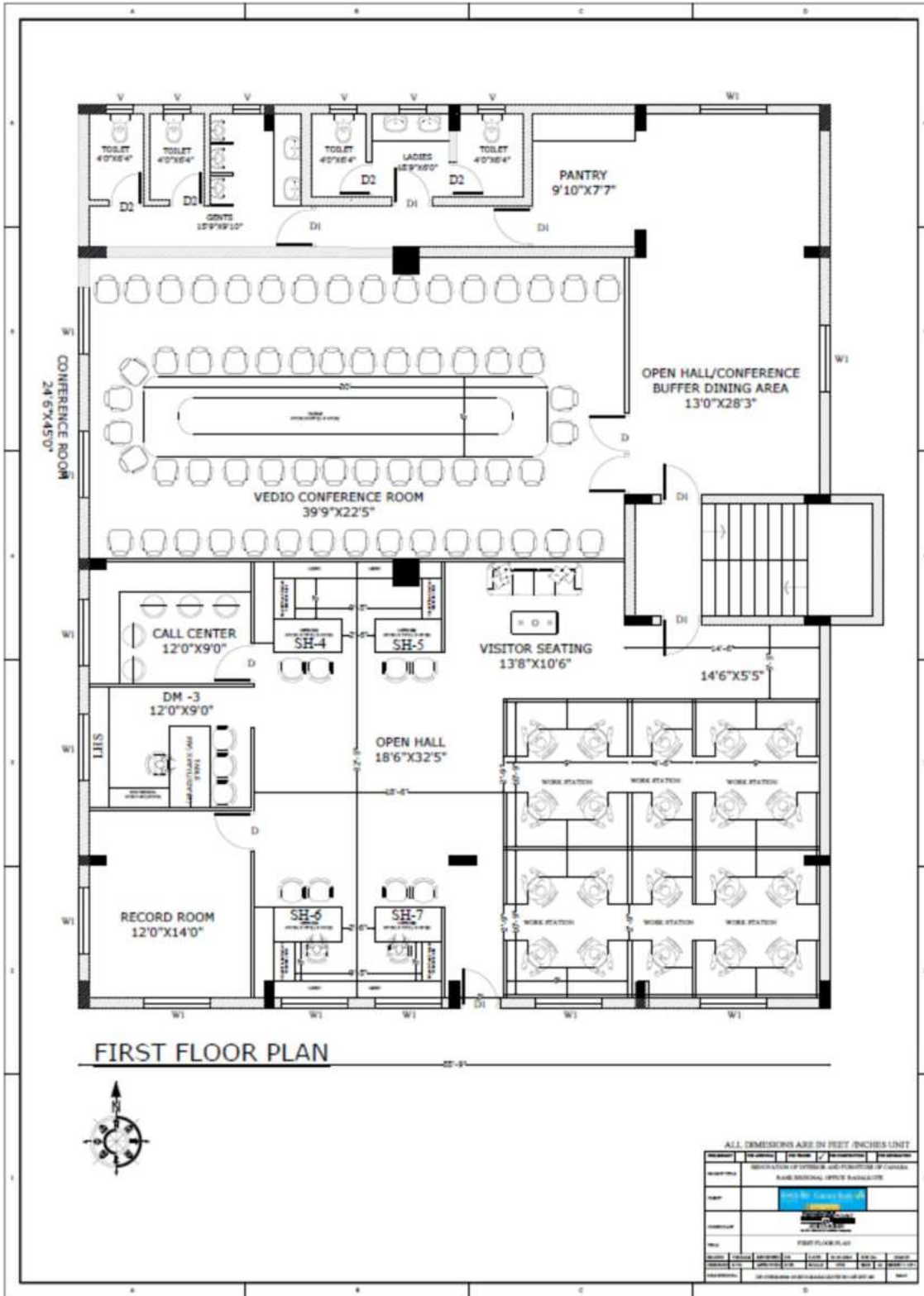

ಸಿಂಡಿಕೇಟ್ ಸಿಂಡಿಕೇಟ್ Syndicate

NIT Ref. COHUB: P&E:DPJ:6925:49: 2024-25 dated 26.12.2024

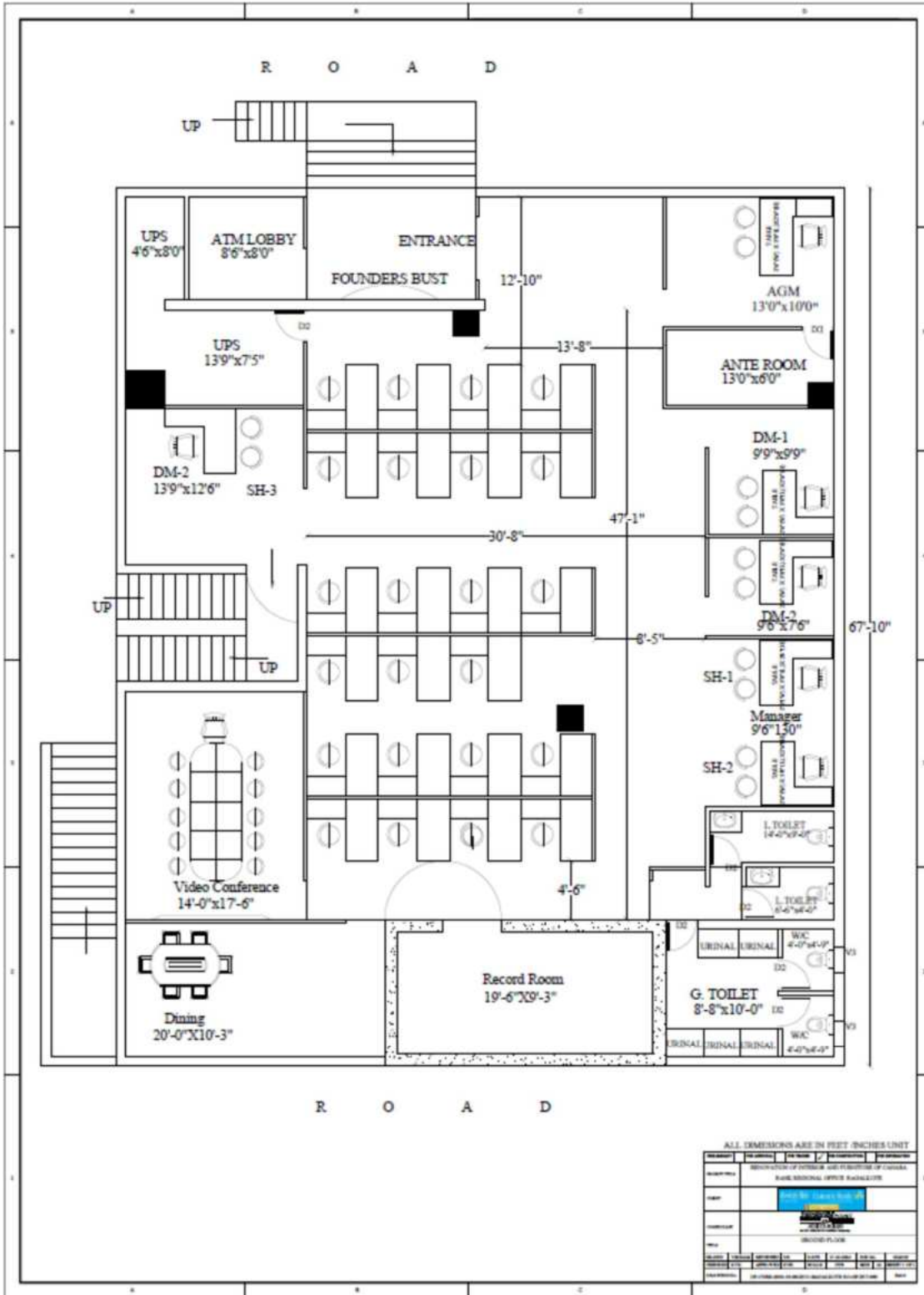

FIRST FLOOR

NO	DESCRIPTION OF ITEM OF WORKS	UNIT	QTY	RATE(INR)	AMOUNT(INR)
1	GYPSUM BOARD FALSE CEILING	SFT	1000.00		
	Providing and fixing suspended false ceiling, which includes providing and fixing GI perimeter channels of size 0.55mm thick having one flange of 20mm and another flange of 30mm and a web of 27mm along with perimeter of ceiling, screw fixed to brick wall/partition with the help of nylon sleeves and screws at 610mm centers. The suspending GI intermediate channel of size 45mm, 0.9mm thick with two flanges of 15mm each from the soffit at 1220mm centers with ceiling angle of width 25mmx 10mmx 0.55mm thick fixed to soffit with GI cleat and steel expansion fastene. Ceiling section of 0.55mm thickness having knurled web of 51.5mm and two flanges of 26mm each with lips of 10.5mm are then fixed to the intermediate channel with the help of connecting clips and in direction perpendicular to the intermediate channel at 457mm centers. 12.5mm tapered edge Gypboard (Conforming to IS- 2095-1982) is then screwed fixed to ceiling section with 25mm dry wall screw at 230mm centers.				
	Screw fixing is done mechanically.Finally the boards are to be jointed and finished so as to have a flush look which includes filling as finishing the tapered and square edge of the boards with joining compound, paper tape and two coats of primer suitable for Gypboard (as equivalent) extra frame work for electrical fittings, A/C diffusers, and/or any other cutout, trap doors, wooden shadow battens (hollock wood black enamel painted 25x40mm) at wall peripheries and ends, 12mm thick PLY WOOD for pelmet etc. complete including opening to be made for AC grills, light fittings, trap doors etc. (The quoted rate shall be inclusive of suspenders at all heights) (The rate including 2 coats of wall care putty and one coat of primer and two coats of emulsion paint.)				
2	MINERAL FIBRE BOARD GRID TYPE FALSE CEILING	SFT	1760.00		
	Providing, fabricating, erecting lay-in type tegular/ drop type ARMSTRONG make mineral fibre board false Ceiling of 600mm x 600mm grid as per the following specifications.				
	The grid system having 600mm x 600 mm or part thereof wherever necessary, shall be made using hot dipped galvanized steel section, exposed surface chemically cleaned capping prefinished in backed polyester paint, main Tee of size 14 x 38 x 0.33mm at every 1200mm c/c max and rotary stitched cross tee of size 14 x 38 x 0.33mm at every 600mm c/c and cross Tee of size 14x 38 x 0.33mm at every 1200 c/c max and 14 x 22 x 0.457mm wall angle around the wall to form grid size of 600 x 600mm. The suspension system shall have 4mm dia pre-straightened GI rods which are in-turn supported from real ceiling using 6mm size anchor bolts, connected with adjustable Hanger clips/ J bolts and other accessories as per the manufacturers specifications. Provide black T junction				

NIT Ref. COHUB: P&E:DPJ:6925:49: 2024-25 dated 26.12.2024

	and the T Sections have a Galvanizing of 120 grams per M2 & passed through for 500 hrs of Salt test .				
	The tiles/ panels shall be of prima Fine Fissured Microlook tegular of ARMSTRONG Mineral Fibre Acoustic Ceiling Tiles of size 600 x 600 x 18 mm thick over the formed grid, in module size of 600mm x 600mm x 18mm Thick.				
	The item shall include the cost of additional Tee or L supports & other accessories near the ends/ odd size edges/corners, making necessary openings for electrical light fittings, fire alarm detectors and any other fixtures. No extra payment shall be made for making openings in the panels/ grid for the purpose of light fittings. Item rate shall include all the taxes, transportation, erection, loading & unloading and any other incidental expenditure that may be required to be spent in completing the work in totality as per above specifications. The tiles removed to place light fittings shall be handed over to bank's custody and there may not be any deduction for light fittings area.				
3	PVC FALSE CEILING	SFT	576.00		
	Providing and fixing PVC FALSE CEILING. The Galvanized section of 3" width of 0.5mm thick fixed on the ceiling by gypsum screws/ dash fasteners/welding as required. The pvc panel of standard size 10'x10" of 8 mm thick will be fixed on the galvanized section complete as required including wastage, labours, cartage, scaffolding etc. Complete as per drawings and instructions of the Architect.				
4	WOODEN SOLID PARTITIONS	SFT	925.00		
	Full height solid partitions as per specification including skirting, complete as per drawings and instructions. Complete in all respects. The rate shall be inclusive of the necessary hardware Partition glass to have frosting/ etching/BANK LOGO as per guidelines. Rate to include providing cutouts and provisions to run electrical conduits, switches, etc. Cost include removal of the existing partitions, wastages, transports, loading, unloading charges, labours, materials, tools, lead, lift and etc. Complete as per drawings and instructions of the Architect.				
	Main frame - Aluminum frame work Jindal make 50 x 38 x 1.2 mm metal studs at 600mm c/c both ways with frame below slab soffit for conduit to run above. All verticals secured to slab ceiling.				
	Skin- Both side with 9.0mm thick BWR Grade IS 303 ply screwed to frame work on both sides with joints as shown or directed. The rate shall be inclusive of Patta with grooves, borders, bottom, middle & top as advised by bank.				
	Finishing: Both side finished in 1.0 mm thk Laminate and All exposed wood work to be finished with melamine polish as shown or directed by Bank/architect.(The partition frame work is to be supported from the true ceiling. Measurement will be taken only below false				

NIT Ref. COHUB: P&E:DPJ:6925:49: 2024-25 dated 26.12.2024

	ceiling.)			
5	WOODEN PARTITIONS USING (Partly Glazed partitions).	SFT	213.00	
	Full height Partly Glazed partitions as per specification including skirting, complete as per drawings and instructions. Complete in all respects. The rate shall be inclusive of the necessary hardware Partition glass to have frosting/ etching/BANK LOGO as per guidelines. Rate to include providing cut-outs and provisions to run electrical conduits, switches, etc. Cost include removal of the existing partitions, wastages, transports, loading, unloading charges, labours, materials, tools, lead, lift and etc. Complete as per drawings and instructions of the Architect.			
	Main frame -Aluminum frame work Jindal make 50mmx50mm(2mm thick) metal studs at 600mm c/c both ways with frame below slab soffit for conduit to run above. All verticals secured to slab ceiling.			
	Skin- Both side with 6.0mm thick BWR Grade IS 303 ply screwed to frame work on both sides with joints as shown or directed. The rate shall be inclusive of Patta with grooves, borders, bottom, middle & top as advised by bank.			
	GLASS - 8MM TOUGHENED GLASS with etching of approved design and drawing fixed with 32x10mm thk teak wood beading polished with melamine polish. shown in the drawing or as directed by Architect.			
	Finishing: Both side finished in 1.0 mm thk Laminate and All exposed wood work to be finished with melamine polish as shown or directed by Bank/architect.(The partition frame work is to be supported from the true ceiling. Measurement will be taken only below false ceiling.)			
6	FULL GLAZED TOUGHNED GLASS PARTITION	SFT	69.00	
	Providing and fixing of full Glass partition with 12mm thick toughened glass using Standard fittings of approved makes at the top and grouting at the bottom with U - Shaped Aluminium rails and EPDM gaskets including cutting, making holes in glass and fixing the fittings in floors, false ceiling etc. and making the same good with necessary screw, sealent wherever required. Includes frosted films.The top fittings to be fitted to the Wooden section fixed above the Gypsum board in the level of GI channels of False ceiling.(the solid partition above toughned glass will count under solid partion not under toughned glass partion.For measurement area from finished floor level to finished false ceiling level will be considered) (BANK LOGO to be provided as per EIC/guidelines).			
7	Panelling on Wall & Column With Aluminium Frames	SFT	685.00	
	Providing and fixing panelling on wall/column. as per specification including skirting, complete as per drawings and instructions. Complete in all respects. The rate shall be inclusive of the necessary hardware, etc complete.			
	Main frame - Aluminum frame 16g work Jindal make			

NIT Ref. COHUB: P&E:DPJ:6925:49: 2024-25 dated 26.12.2024

	50mmx50mm metal studs at 600mm c/c both ways with frame below slab soffit for conduit to run above. All verticals secured to slab ceiling.				
	Skin- Both side with BWR Grade IS 303 plywood screwed to frame work on both sides with joints as shown or directed. The rate shall be inclusive of Patta with grooves, borders, bottom, middle & top as advised by bank.				
	Laminate-1.0 mm thick (Approved Colour Scheme)				
8	GLASS DOOR	SFT	63.00		
	Providing, fabricating and fixing in position 12mm thick edge polished toughened glass shutters. The quoted rate shall include necessary MS supports etc. required to hold the Glass door from the true slab adhering to the manufacturer's specification and catalogue. The 60% of glass surface shall be fixed with approved make of frosted film/etching film to pattern as directed by EIC. This also includes providing and fixing in position necessary etching film / LOGO, approved patch fitting locking systems, stainless steel brush finished hardware like concealed handles, door stopper, concealed door locks, screws, floor spring, of godrej/everite/dorma make etc all complete as recommended by the Architect/EIC				
9	ROLLER BLINDS.	SFT	210.00		
	Providing & Fixing Roller Blinds with Alluminium alloys head rail shall be 38 m.m. with control unit, shall be made of high grade Polymer and shall not used inside the head rail which shall transformation from chain. Chain shall be made of plastic beads for operation. Use black out fabric with no openness factor and bottom pipe should be cover by both side round end cap etc. all Complete. as per the directions of the engineer in charge. (Basic Price of blinds Rs 90/- per Sqft.)				
10	T1- MANEGER TABLE	NOS	1.00		
	TABLE Size- 5'-0"(L) X 3'-0"(W) X 2'-6"(D)				
	Key Board Tray- 19.0mm thick BWR Grade IS 303 ply for frame work with 1mm laminate the unit shall have guides, sliding units etc.				
	Table top to be made with 25mm thick BWR Grade IS 303 Plywood 180 degree (full round) post formed edges on two sides of appoved post forming laminate shade and colour. Drawer unit and openable storage shutter to be finished with 90 degree (Half round) post formed edges on two vertical sides. 19mm thick BWR Grade IS 303 plywood frame work in all sides with one keyboard tray, one side one drawer, side and back storage with 19mm BWR Grade IS 303 plywood shelf provision, CPU stand and footrest. Key board tray and drawer telescopic slides make of godrej/ebco only others				
	All exposed surfaces, Table top, and front apron finished with 1mm thick laminate of bank branding colours. Internal surfaces finished with 0.8mm thick laminate of white colour of approved brand. Plywood edges to be finished with 2mm thick machine pressed edge band of approved colour. Necessary hardware such as locks,				

NIT Ref. COHUB: P&E:DPJ:6925:49: 2024-25 dated 26.12.2024

	hinges, telescopic drawer slides, handles and wire manager are approved make. Cost include 12mm toughend glass for table top with edge machine polish and wire manager holes. Cost include wastages, transports, loading, unloading charges, labours, materials, tools, lead, lift and etc. Complete as per drawings and instructions of the Architect.				
11	T2- SH TABLE	NOS	4.00		
	TABLE Size- 5'-0"(L) X 2'-6"(W) X 2'-6"(D)				
	Other specifications as per Table T1 design & drawing				
12	WORK STATION	EA	16.00		
	Supplying and installation of Workstation as per specification size: 1350 x 1200 x 1200 mm WDH, compliant to Greenguard standards Table top - 25mm thick Pre Laminated board confirming to IS:3087 laminated with laminate of thickness 0.8mm confirming to IS: 2046 and glued with PVAC. 2mm PVC lipping to be done which is glued with Hot melt EVA glue. 600mm depth at 1350 side and 450 mm depth at 1200 side to be given Panels thickness: 1350 mm side panel should be of thickness 52.4mm and 1200mm side panel should have thickness 22.8mm Panel constructions:Panels should have horizontal construction. 52.4mm panel construction: Vertical trim and horizontal trims should be made of Aluminium extrusions. 4 tiles should be given where as top tile should have one writing board (16mm thick particle board laminated with 0.6mm thick white glossy high pressure laminate on both sides and having all its edges with minimum 0.5 mm thick PVC edging)and one fabric magnetic board(Fabric magnetic tiles should be fabric upholstered metal tiles in 0.6 mm thick G.I. Grade O as per IS: 277. The fabrics should be upholstered with adhesives). Middle panels should be made of Laminate(52.4mm panel's thickness should comprise of 38mm thick paper honeycomb with 3mm MDF on each sides and 0.6mm decorative laminate)Particle board framing should be used on outer boundary of these blocks as well as intermediately at certain locations forming conduit for passing cables. These blocks should be located in the middle bands of the panels. All bottom tiles should be press fitted on to the assembly frame of the panel with the help of snap on clips made of nylon-66 and support clips made from PP polymer. Bottom panel should be powder coated metal tiles in 0.8 mm thick M.S. CRCA Grade D as per IS: 513 .				
	Pedestal construction: welded assembled , 2mm thick CRCA for Body Shell, Top panel & Bottom stiffener reinforcement member, 1.2mm thick CRCA for Drawer fronts, Top panel Brackets & Top Bottom Stiffener, 0.8mm thick CRCA for Drawer, Drawer Inner Cover, Drawer back cover, Front& Rear Side Stiffeners & bottom panel. Locking: 10 lever Cam Lock & Central RH locking with actuator & lock channel mechanism. Cushion: 386mm(W) x 448 (D) x 81 mm (H) size leatherette upholstered PU foam cushion to be fitted above top panel using M6 screws. PU				

NIT Ref. COHUB: P&E:DPJ:6925:49: 2024-25 dated 26.12.2024

	foam density 45 kg /m3 and hardness 20+-2 @ 25% compression to be given. Swivelling lockable castors of dia 50 mm to be fitted and anti tipping fifth roller arrangement has to be given. All metal components should be coated with Epoxy powder coating of thickness 50 microns 1200 mm side bottom to be covered with 18mm thick both side Pre laminated particle board of interior grade of approved shade conforming to IS: 12823 Accessories: Metal CPU trolley, Key board tray with . Key board tray should have sturdy plastic body and with the mouse pad. Tray size should be 540mm* 197mm Name plate, Pen holder should be made of 0.8mm thick CRCA sheet of Grade D with epoxy powder coating. It should be slid to any convenient location along the groove in the horizontal extrusion Steel Monitor arm which will be fitted on the work top with clamp to be given. 3 way adjustment option to be given (Height, angle, distance from the user), Preferred make is Innofit. It should be suitable to fit all VESA standard monitors from 75mm to 100mm. Wire management: All data and electrical wiring to be carried through panels only. Cut outs to be provided above worktop and below the worktop also for easy access of Power sockets etc. as directed by engineer in charge.				
	Refer : Drawing No - 1				
13	CONFERENCE TABLE	RFT	40.00		
	Table top to be made with 25mm thick BWR Grade IS 303 Plywood 180 degree (full round) post formed edges on two sides of approved post forming laminate shade and colour. Drawer unit and openable storage shutter to be finished with 90 degree (Half round) post formed edges on two vertical sides. 19mm thick BWR Grade IS 303 plywood frame work in all sides with one keyboard tray, one side one drawer, side and back storage with 19mm BWR Grade IS 303 plywood shelf provision, CPU stand and footrest. Key board tray and drawer telescopic slides make of godrej/ebco only others				
	All exposed surfaces, Table top, and front apron finished with 1mm thick laminate of bank branding colours. Internal surfaces finished with 0.8mm thick laminate of white colour of approved brand. Plywood edges to be finished with 2mm thick machine pressed edge band of approved colour. Necessary hardware such as locks, hinges, telescopic drawer slides, handles and wire manager are approved make. Cost include 12mm toughend glass for table top with edge machine polish and wire manager holes. Cost include wastages, transports, loading, unloading charges, labours, materials, tools, lead, lift and etc. Complete as per drawings and instructions of the Architect.				
	Refer : Drawing No - 2				
14	WOODEN SOLID CORE FLUSH DOORS				
	Providing & fixing wooden solid core flush shutters of 35 mm thickness with both side ply and around wooden frame work. The top 4 feet portion shall be finished with 6mm thick plain glass fixed with wooden moulded				

NIT Ref. COHUB: P&E:DPJ:6925:49: 2024-25 dated 26.12.2024

	beadings & pasted with frosted film having Bank's logo and strips as per the design provided by Engineer-in-charge.				
	The both sides of the shutter shall be finished with 1 mm thick approved colour & brand laminate. The around edges shall be with teak wood lipping beading. The door shall be fixed to the partition frame work using 4 nos stainless steel hinges, 2 nos 6" size S S handles, one 6 lever SS finished Mortice lock of Laxmi make, one number 6 levered Godrej make (with minimum 3 keys) automatic NIGHT LATCH fixed just below 3 feet level for Cash and single Window, door closure of Everite make, door stopper. The payment is per number of 3'x7'/2'6"x7' size. Any variation in size will be paid on proportionate basis. (MAKE: GREENPLY WOODEN DOORS, CENTURYPLY PLYWOOD, ARCHIDPLY, KITPLY)				
a	Door Size: 3'0"x7'0"	NOS	5.00		
b	Door Size: 2'6"x7'0"	NOS	4.00		
15	LOW and FULL HT STORAGES	SFT	85.00		
	Providing and fixing Full / Low height Storage as PER SPECIFICATIONS				
	Skeleton - made out of 19 mm. Thk BWR Grade IS 303 ply at end verticals, top and bottom and verticals 450mm to 600mm Centres as shown in drawing and 6 mm thk back ply.				
	SHELVES - 19mm Thk. Plywood top and edges finished in 1.0mm thk. Laminate to accommodate file height removable and supported on pins				
	SHUTTERS-made out of 19mm thk. BWR Grade IS 303 ply externally finished in 1.0mm thk. Laminate and Internally finished 0.8mm thick laminate				
	HINGES - Each shutter shall have 100mm long black oxidised brass butt hinges. Mimimum 4 nos. hinges for Full height Storage and 2 Nos. hinges for Low Height Storage to be provided.				
	BOLTS - Flush tower bolts from inside at top and bottom to the required shutters only - other shutters will have magnetic catch fixed top and bottom.				
	LOCKS - of approved make 4 -lever brass body dead lock with S.S. Key - master key for groups as required.				
	HANDLES - 100mm wide handles of brushed steel or c.p. brass handle as approved by the Architect.				
	BACK - Back side of storage to have 6mm thk. commercial ply with paint				
	Finishing :- All internal and external surface finish with 1.0 mm thk Laminate. Internal surfaces finished with 0.8mm thick laminate of white colour of approved brand. Plywood edges to be finished with 2mm thick machine pressed edge band of approved colour. Necessary hardware such as locks, hinges, telescopic drawer slides, handles are approved make including back to have coat of anti termite of approved make before polishing / lamination.				
16	GLASS SHELVES	NOS	20.00		

NIT Ref. COHUB: P&E:DPJ:6925:49: 2024-25 dated 26.12.2024

	Providing and fixing glass panes of required sizes (like 1 ft x 2 ft, 9" x 15" etc) with all edges neatly grinded & polished and fixed to the wall surfaces using ss D brackets/suitable ss fittings . The glass shall be 12mm thk plain glass of Modi,saint Gobain,asahi make.				
17	NOTICE BOARD	SFT	12.00		
	Providing and fixing notice board 3'0" X 2'0" size as mentioned to be made out of 19mm thk. ply with 3" deep with front glass shutter, 10mm thk. ply back covered with soft board and felt cloth including polishing locks etc. finished as per instruction of the Architect.				
18	LOGO				
	Providing, fabrication and fixing of logo made of acrylic cut out letters with LED and reflective vinyl sheet as per approved design with following a) logo shall be fabricated with 3 mm thick ACP sheets. Powder coated Aluminium sheet shall be fixed from the rear side of the entire board to make box section. b) Logo shall be made of Acrylic cutout and shall be uniformly illuminated by using Digital LED light of approved make. c) Powder coated Aluminum clips and brackets shall be used of minimum 3 mm thickness as per direction of Engineer In charge.				
a	BANKING HALL CELLING	SFT	16.00		
b	BRANCH HEAD CABIN	SFT	9.00		
19	CENTER TABLE	NOS	1.00		
	Center Table Round,Tempered glass, Single storage in bottom portion, Size 533 (D)x510(H)				
20	STRUCTURAL GLAZING	NOS	560.00		
	Designing, engineering, providing and fixing sealed and air, water and weather tight Aluminum semi unitized structural glazing system to support / hold glass of approved make having main frame work of mullions and transoms of specially designed extruded sections to withstand a wind pressure of minimum 100 kg./ Sqm and fabricated fixed at all levels, elevation & heights. The extruded section shall be finished, with electrolytic colour powder coated of approved shade. Extruded to IS-63400. Machine cut glass infill panels (of size as per the design) made of 5mm thick glass of SAINT GOBAIN heat Strengthened Reflective glass Rate shall include fixing of the main frames to RC concrete surface with necessary Clamps. Fastening straps, nuts, bolts, rivets, washers and other fastening materials shall be in stainless steel. Rate shall include EPDM / Neoprene triple barrier, approved silicon sealant of recommended grade from DOW corning / equivalent etc. complete for a full proof system. Rate including cost of material, labours, lifting charges etc. As required for the completion of the work as per the approved manufacturer's specification/ drawing/design/instruction of engineer in-charge. (Approved brand for alluminium Jindal/ Hindalco).				
Total Excluding GST					



GROUND FLOOR

NO	DESCRIPTION OF ITEM OF WORKS	UNIT	QTY	RATE(INR)	AMOUNT(INR)
1	GYPSUM BOARD FALSE CEILING	SFT	300.00		
	Providing and fixing suspended false ceiling, which includes providing and fixing GI perimeter channels of size 0.55mm thick having one flange of 20mm and another flange of 30mm and a web of 27mm along with perimeter of ceiling, screw fixed to brick wall/partition with the help of nylon sleeves and screws at 610mm centers. The suspending GI intermediate channel of size 45mm, 0.9mm thick with two flanges of 15mm each from the soffit at 1220mm centers with ceiling angle of width 25mmx 10mmx 0.55mm thick fixed to soffit with GI cleat and steel expansion fastene. Ceiling section of 0.55mm thickness having knurled web of 51.5mm and two flanges of 26mm each with lips of 10.5mm are then fixed to the intermediate channel with the help of connecting clips and in direction perpendicular to the intermediate channel at 457mm centers. 12.5mm tapered edge Gypboard (Conforming to IS- 2095-1982) is then screwed fixed to ceiling section with 25mm dry wall screw at 230mm centers.				
	Screw fixing is done mechanically.Finally the boards are to be jointed and finished so as to have a flush look which includes filling as finishing the tapered and square edge of the boards with joining compound, paper tape and two coats of primer suitable for Gypboard (as equivalent) extra frame work for electrical fittings, A/C diffusers, and/or any other cutout, trap doors, wooden shadow battens (hollock wood black enamel painted 25x40mm) at wall peripheries and ends, 12mm thick PLY WOOD for pelmet etc. complete including opening to be made for AC grills, light fittings, trap doors etc. (The quoted rate shall be inclusive of suspenders at all heights) (The rate including 2 coats of wall care putty and one coat of primer and two coats of emulsion paint.)				
2	MINERAL FIBRE BOARD GRID TYPE FALSE CEILING	SFT	500.00		
	Providing, fabricating, erecting lay-in type tegular/ drop type ARMSTRONG make mineral fibre board false Ceiling of 600mm x 600mm grid as per the following specifications.				
	The grid system having 600mm x 600 mm or part thereof wherever necessary, shall be made using hot dipped galvanized steel section, exposed surface chemically cleaned capping prefinished in backed polyester paint, main Tee of size 14 x 38 x 0.33mm at every 1200mm c/c max and rotary stitched cross tee of size 14 x 38 x 0.33mm at every 600mm c/c and cross Tee of size 14x 38 x 0.33mm at every 1200 c/c max and 14 x 22 x 0.457mm wall angle around the wall to form grid size of 600 x 600mm. The suspension system shall have 4mm dia pre-straightened GI rods which are in-turn supported from real ceiling using 6mm size anchor bolts, connected with adjustable Hanger clips/ J bolts and other accessories as per the manufacturers specifications. Provide black T junction and the T Sections have a Galvanizing of 120 grams per M2 & passed through for 500 hrs of Salt test .				

NIT Ref. COHUB: P&E:DPJ:6925:49: 2024-25 dated 26.12.2024

	The tiles/ panels shall be of prima Fine Fissured Microlook tegular of ARMSTRONG Mineral Fibre Acoustic Ceiling Tiles of size 600 x 600 x 18 mm thick over the formed grid, in module size of 600mm x 600mm x 18mm Thick.				
	The item shall include the cost of additional Tee or L supports & other accessories near the ends/ odd size edges/corners, making necessary openings for electrical light fittings, fire alarm detectors and any other fixtures. No extra payement shall be made for making openings in the panels/ grid for the purpose of light fittings. Item rate shall include all the taxes, transporation, erection, loading & unloading and any other incidental expenditure that may be required to be spent in completing the work in totality as per above specifications.The tiles removed to place light fittings shall be handed over to bank's custody and there may not be any deduction for light fittings area.				
3	WOODEN SOLID PARTITIONS	SFT	79.00		
	Full height solid partitions as per specification including skirting, complete as per drawings and instructions. Complete in all respects. The rate shall be inclusive of the necessary hardware Partition glass to have frosting/ etching/BANK LOGO as per guidelines. Rate to include providing cutouts and provisions to run electrical conduits, switches, etc. Cost include removal of the existing partitions, wastages, transports, loading, unloading charges, labours, materials, tools, lead, lift and etc. Complete as per drawings and instructions of the Architect.				
	Main frame – Aluminum frame work Jindal make 50 x 38 x 1.2 mm metal studs at 600mm c/c both ways with frame below slab soffit for conduit to run above. All verticals secured to slab ceiling.				
	Skin- Both side with 9.0mm thick BWR Grade IS 303 ply screwed to frame work on both sides with joints as shown or directed. The rate shall be inclusive of Patta with grooves, borders, bottom, middle & top as advised by bank.				
	Finishing: Both side finished in 1.0 mm thk Laminate and All exposed wood work to be finished with melamine polish as shown or directed by Bank/architect.(The partition frame work is to be supported from the true ceiling. Measurement will be taken only below false ceiling.)				
4	WOODEN PARTITIONS USING (Partly Glazed partititions).	SFT	72.00		
	Full height Partly Glazed partitions as per specification including skirting, complete as per drawings and instructions. Complete in all respects. The rate shall be inclusive of the necessary hardware Partition glass to have frosting/ etching/BANK LOGO as per guidelines. Rate to include providing cut-outs and provisions to run electrical conduits, switches, etc. Cost include removal of the existing partitions, wastages, transports, loading, unloading charges, labours, materials, tools, lead, lift and etc. Complete as per drawings and instructions of the Architect.				
	Main frame –Aluminum frame work Jindal make 50mmx50mm(2mm thick) metal studs at 600mm c/c both ways with frame below slab soffit for conduit to run above. All verticals secured to slab ceiling.				

NIT Ref. COHUB: P&E:DPJ:6925:49: 2024-25 dated 26.12.2024

	Skin- Both side with 6.0mm thick BWR Grade IS 303 ply screwed to frame work on both sides with joints as shown or directed. The rate shall be inclusive of Patta with grooves, borders, bottom, middle & top as advised by bank.				
	GLASS - 8MM TOUGHENED GLASS with etching of approved design and drawing fixed with 32x10mm thk teak wood beading polished with melamine polish. shown in the drawing or as directed by Architect.				
	Finishing: Both side finished in 1.0 mm thk Laminate and All exposed wood work to be finished with melamine polish as shown or directed by Bank/architect.(The partition frame work is to be supported from the true ceiling. Measurement will be taken only below false ceiling.)				
5	FULL GLAZED TOUGHENED GLASS PARTITION	SFT	78.00		
	Providing and fixing of full Glass partition with 12mm thick toughened glass using Standard fittings of approved makes at the top and grouting at the bottom with U - Shaped Aluminium rails and EPDM gaskets including cutting, making holes in glass and fixing the fittings in floors, false ceiling etc. and making the same good with necessary screw, sealant wherever required. Includes frosted films .The top fittings to be fitted to the Wooden section fixed above the Gypsum board in the level of GI channels of False ceiling.(the solid partition above toughned glass will count under solid partion not under toughned glass partion.For measurement area from finished floor level to finished false ceiling level will be considered) (BANK LOGO to be provided as per EIC/guidelines) .				
6	Panelling on Wall & Column With Aluminium Frames	SFT	0		
	Providing and fixing panelling on wall/column. as per specification including skirting, complete as per drawings and instructions. Complete in all respects. The rate shall be inclusive of the necessary hardware, etc complete.				
	Main frame – Aluminum frame 16g work Jindal make 50mmx50mm metal studs at 600mm c/c both ways with frame below slab soffit for conduit to run above. All verticals secured to slab ceiling.				
	Skin- Both side with BWR Grade IS 303 plywood screwed to frame work on both sides with joints as shown or directed. The rate shall be inclusive of Patta with grooves, borders, bottom, middle & top as advised by bank.				
	Laminate-1.0 mm thick (Approved Colour Scheme)				
7	GLASS DOOR	SFT	77.00		
	Providing, fabricating and fixing in position 12mm thick edge polished toughened glass shutters. The quoted rate shall include necessary MS supports etc. required to hold the Glass door from the true slab adhering to the manufacturer’s specification and catalogue. The 60% of glass surface shall be fixed with approved make of frosted film/etching film to pattern as directed by EIC. This also includes providing and fixing in position necessary etching film / LOGO, approved patch fitting locking systems, stainless steel brush finished hardware like concealed handles, door stopper, concealed door locks, screws, floor spring, of				

NIT Ref. COHUB: P&E:DPJ:6925:49: 2024-25 dated 26.12.2024

	godrej/everite/dorma make etc all complete as recommended by the Architect/EIC				
8	ROLLER BLINDS.	SFT	198.00		
	Providing & Fixing Roller Blinds with Alluminium alloys head rail shall be 38 m.m. with control unit, shall be made of high grade Polymer and shall not used inside the head rail which shall transformation from chain. Chain shall be made of plastic beads for operation. Use black out fabric with no openness factor and bottom pipe should be cover by both side round end cap etc. all Complete. as per the directions of the engineer in charge. (Basic Price of blinds Rs 90/- per Sqft.)				
9	T1- AGM TABLE(WITH GLASS TOP)	NOS	1.00		
	TABLE Size- 6'-0"(L) X 2'-6"(W) X 2'-6"(D)				
	Key Board Tray- 19.0mm thick BWR Grade IS 303 ply for frame work with 1mm laminate the unit shall have guides, sliding units etc.				
	Table top to be made with 25mm thick BWR Grade IS 303 Plywood 180 degree (full round) post formed edges on two sides of appoved post forming laminate shade and colour. Drawer unit and openable storage shutter to be finished with 90 degree (Half round) post formed edges on two vertical sides. 19mm thick BWR Grade IS 303 plywood frame work in all sides with one keyboard tray, one side one drawer, side and back storage with 19mm BWR Grade IS 303 plywood shelf provision, CPU stand and footrest. Key board tray and drawer telescopic slides make of godrej/ebco only others				
	All exposed surfaces, Table top, and front apron finished with 1mm thick laminate of bank branding colours. Internal surfaces finished with 0.8mm thick laminate of white colour of approved brand. Plywood edges to be finished with 2mm thick machine pressed edge band of approved colour. Necessary hardware such as locks, hinges, telescopic drawer slides, handles and wire manager are approved make. Cost include 12mm toughend glass for table top with edge machine polish and wire manager holes. Cost include wastages, transports, loading, unloading charges, labours, materials, tools, lead, lift and etc. Complete as per drawings and instructions of the Architect.				
10	WOODEN SOLID CORE FLUSH DOORS				
	Providing & fixing wooden solid core flush shutters of 35 mm thickness with both side ply and alround wooden frame work. The top 4 feet portion shall be finished with 6mm thick plain glass fixed with wooden moulded beadings & pasted with frosted film having Bank's logo and strips as per the design provided by Engineer-in-charge.				
	The both sides of the shutter shall be finished with 1 mm thick approved colour & brand laminate. The alround edges shall be with teak wood lipping beading. The door sall be fixed to the partition frame work using 4 nos stainless steel hinges, 2 nos 6" size S S handles, one 6 lever SS finished Mortice lock of Laxmi make, one number 6 levered Godrej make (with minimum 3 keys) automatic NIGHT LATCH fixed just below 3 feet level for Cash and single Window, door closure of Everite make, door				

NIT Ref. COHUB: P&E:DPJ:6925:49: 2024-25 dated 26.12.2024

	stopper. The payment is per number of 3'x7'/2'6"x7' size. Any variation in size will be paid on proportionate basis.(MAKE: GREENPLY WOODEN DOORS, CENTURYPLY PLYWOOD, ARCHIDPLY, KITPLY)				
a	Door Size: 3'0"x7'0"	NOS	2.00		
b	Door Size: 2'6"x7'0"	NOS	2.00		
11	LOW and FULL HT STORAGES	SFT	15.00		
	Providing and fixing Full / Low height Storage as PER SPECIFICATIONS				
	Skeleton - made out of 19 mm. Thk BWR Grade IS 303 ply at end verticals, top and bottom and verticals 450mm to 600mm Centres as shown in drawing and 6 mm thk back ply.				
	SHELVES - 19mm Thk. Plywood top and edges finished in 1.0mm thk. Laminate to accommodate file height removable and supported on pins				
	SHUTTERS-made out of 19mm thk. BWR Grade IS 303 ply externally finished in 1.0mm thk. Laminate and Internally finished 0.8mm thick laminate				
	HINGES - Each shutter shall have 100mm long black oxidised brass butt hinges. Mimimum 4 nos. hinges for Full height Storage and 2 Nos. hinges for Low Height Storage to be provided.				
	BOLTS - Flush tower bolts from inside at top and bottom to the required shutters only - other shutters will have magnetic catch fixed top and bottom.				
	LOCKS - of approved make 4 -lever brass body dead lock with S.S. Key - master key for groups as required.				
	HANDLES - 100mm wide handles of brushed steel or c.p. brass handle as approved by the Architect.				
	BACK - Back side of storage to have 6mm thk. commercial ply with paint				
	Finishing :- All internal and external surface finish with 1.0 mm thk Laminate. Internal surfaces finished with 0.8mm thick laminate of white colour of approved brand. Plywood edges to be finished with 2mm thick machine pressed edge band of approved colour. Necessary hardware such as locks, hinges, telescopic drawer slides, handles are approved make including back to have coat of anti termite of approved make before polishing / lamination.				
12	GLASS SHELFs	NOS	20.00		
	Providing and fixing glass panes of required sizes (like 1 ft x 2 ft, 9" x 15" etc) with all edges neatly grinded & polished and fixed to the wall surfaces using ss D brackets/suitable ss fittings . The glass shall be 12mm thk plain glass of Modi,saint Gobain,asahi make.				
13	NOTICE BOARD	SFT	0		
	Providing and fixing notice board 3'0" X 2'0" size as mentioned to be made out of 19mm thk. ply with 3" deep with front glass shutter, 10mm thk. ply back covered with soft board and felt cloth including polishing locks etc. finished as per instruction of the Architect.				
14	LOGO				

NIT Ref. COHUB: P&E:DPJ:6925:49: 2024-25 dated 26.12.2024

	Providing, fabrication and fixing of logo made of acrylic cut out letters with LED and reflective vinyl sheet as per approved design with followinga) logo shall be fabricated with 3 mm thick ACP sheets. Powder coated Aluminium sheet shall be fixed from the rear side of the entire board to make box section.b) Logo shall be made of Acrylic cutout and shall be uniformly illuminated by using Digital LED light of approved make.c) Powder coated Aluminum clips and brackets shall be used of minimum 3 mm thickness as per direction of Engineer In charge.				
a	BANKING HALL CELLING	SFT	0		
b	BRANCH HEAD CABIN	SFT	0		
15	Lamination of Existing furniture and paneling works with 1 MM laminate of approved shade and pattern with design all complete as per instruction	SFT	2700.00		
16	DISMANTLING/ SHIFTING/ REFIXING/ WORKS:				
a	Dismantling existing Partitions, counters/ tables/false ceiling after stage wise progress of work and stocking of serviceable material and disposal of unserviceable material from the site as directed by the bank officials.	LS			
b	Making necessary arrangement for the branch to function smoothly during the progress of renovation work that includes rearrangement of existing set up as required by branch from time to time.	JOB			
Total Excluding GST					

NIT Ref. COHUB: P&E:DPJ:6925:49: 2024-25 dated 26.12.2024

CIVIL & OTHER MINOR WORKS

NO	DESCRIPTION OF ITEM OF WORKS	UNIT	QTY	RATE(INR)	AMOUNT(INR)
1	DISMANTLING WORK	CFT	0		
	Dismantling of masonry parapet wall, existing brick masonry work and others by means of chipping /breaking with due care and safety for all heights and depths including supply of tools tackles, necessary scaffolding, cleaning and shifting of derbies outside Premises within a lead of 5 km, as per direction of engineer in-charge.				
2	P.C.C M10	CFT	25.00		
	Providing and laying in position plain cement concrete of mix M10 with OPC cement @ 220 kgs, with 40mm and down size graded granite metal course aggregates @ 0.892 cum and fine aggregates @ 0.465 cum machine mixed, concrete laid in layers not exceeding 15 cms. thick, well compacted, in foundation and plinth, including cost of all materials, labour, HOM of machinery, curing complete as per specifications				
3	BRICK MASONRY New Ante Room	CFT	231.00		
	Providing and constructing Brick Masonry in CM 1:6 with first class wire cut bricks of approved quality and size including scaffolding ,curing, raking out of joint etc (Excluding Plaster) complete as per specification, drawing and as directed by EIC.				
4	INTERNAL WALL PLASTERING	SFT	696.00		
	Providing and applying average 15MM thick cement plaster CM 1:4 in two layers including preparing the surface, scaffolding, providing bands, grooves in plaster, curing etc complete as per specification, drawings & directed by EIC.Joint of RCC and brick wall to be plastered with fixing Galvanised chicken mesh 12X12x24 gauge.				
5	VITRIFIED FLOORING/SKIRTING	SFT	30.00		
	Providing and laying good quality vitrified tile of required size in flooring and skirting with water absorption less than 0.08% and flexural strength not less than 47.3 N/mm ² (shade & colour to be approved by engineer incharge)and to be laid with the help of adhesive balendra or ardex endura including providing spacer at required interval and removing stains, joint filling etc. Joints to be filled with the matching colour pigment.(approved brands - Johnson/Nitco/ Kajaria/Naveen/Somany make). (basic cost of tile is minimum Rs. 850/ sq- mtr.)				
6	CERAMIC TILE WORK	SFT	450.00		
	Providing and laying high quality Ceramic tiles of APPROVED dimension in wall/ floor etc (Anti-skid type for floor) sample for shade and colour to be approved by EIC/PMC, layed over 20mm thick CM 1: 3 and joints shall be admixed with pigment of matching shade as per drawing & specification for flooring, dado work,skirting,etc (basic cost of tile is 550/ sq-mtr.) Johnson/Nitco/ Kajaria/Naveen/Somany make				
7	GRANITE STONE WORK	SFT	750.00		

NIT Ref. COHUB: P&E:DPJ:6925:49: 2024-25 dated 26.12.2024

	Providing and laying minimum 18mm thick approved premium quality and shade mirror polished/LAPATRO granite stone (sample of the granite to be approved by engineer in charged) for flooring, kitchen counters/platform, treads, risers, skirting, dado etc. over and including edge moulding, machine polishing to edge to give high gloss finish laying over a bed of cement mortar 20 mm thick base cement mortar 1:4 (1 cement : 4 coarse sand), preparing the base surface, applying neat cement slurry@ 2.75 kg. of cement per sq. mtr. of area to receive the mortar bed, jointing each slab with neat cement paste/grout with white cement mixed with pigment (conforming to IS:2114, Table-1) to match the colour of the granite stone slabs, finishing etc. all complete. (BASIC RATE OF GRAINTE STONE -2270/sqr-mtr)				
8	UPVC VENTILATOR	SFT	12.00		
	Providing and fixing aluminum ventilators with glass louvers etc. Fabricating, supplying, assembling and installing in position glazed UPVC (unplasticised) windows and ventilators of hollow, multi-chambered and steel reinforced with an outer wall thickness of 2.4-2.8mm, consisting of outer frames, shutter frames, Mullions, transoms, etc assembled and fitted properly, glazed panels 100% sliding with 8mm thick Toughened glass of Saint Gobain / Asahi Float including anchoring frames as approved, fixing and other accessories, providing and fixing sub frame in UPVC where called for, all sliding gear, lock and other hardware as required and as approved and all incidental work complete as per drawings and as per manufacturers specifications. The make should be of approved make and from approved vendor, anyway the sample has to be got approved from the Architect /Engineer in charge at site before placing the order. Approved Brand-Fenesta / Evolution /Deceqnick.				
9	INTERNAL PAINTING	SFT	2975.00		
	Providing and applying white cement based putty of average thickness 1mm, of approved brand and one coat primer, 2 coat of Tractor acrylic emulsion as per manufacturer specification over the plastered wall surface to make the surface even and smooth including preparing the surface, curing, complete as per specification, directed by engineer in charge. (Approved brand Birla white, Asian paint, Berger				
10	WATERPROOFING(for toilets)	SFT	80.00		
	Clean the toilet slab thoroughly with wire brush and remove loose plastering and dirt and wash the surface with water completely and leave the surface for drying. Supplying and applying the waterproofing solution made of 1 litre zycosil : 2 litre zycoprime : 17 litre water with spraying machine till saturation of the vertical and horizontal surface of area and upto 150 mm height on the surrounding wall above the floor level as well as filling the cracks in dismantled slab portion with putty made of zycosil primer and cement before spraying including cost				

NIT Ref. COHUB: P&E:DPJ:6925:49: 2024-25 dated 26.12.2024

	of all materials, labour charges, curing etc. complete. Subsequently, supplying and applying 3 or more coats of water proof chemical 1 litre/elastobar of M/s zydex : 1 kg cement brushable slurry to achieve 1 mm thickness of the protective layer. The work also include providing screed protection to the chemical coating with 15mm thick cement mortar 1:4(1 cement: 4 coarse sand). The contractor has to give 5 year water proofing Performance Guarantee for the work as per given format.				
11	DOOR (WPC) FOR TOILETS	SFT	21.00		
	Providing and fixing factory made solid Wood Polymer Composite (WPC) single extruded Door Frame section of size with encapsulation of 8MM rigid layer on all the six surfaces. The door frame will have a rebat of 32MM. Door Frame section of 63.5x100 MM .The two Vertical members are to be joined together with the horizontal member using 8x75 MM long MS Star full thread screws to be used with reverse forward speed control hand drilling machine. The ready/assembled door frame is fixed to the wall using hold fast or bolt fasteners. A minimum of 4 No.sof screws to be provided for each vertical member & minimum 2no.s for horizontal member. 28 -30 MM thick solid Wood Polymer Composite(WPC) single extruded door shutter with 3MM top and bottom rigid layer with an overall density of 750kg/Cum. It will be fixed to the frame using 3 inch /4 inch hinges. A minimum of 4 hinges will be required for fixing the door with the frame. as per direction of Engineer-in-charge includes necessary Stainless steel brush finished hardware of approved make (dorma/Godrej/Everite) like handles, screws, tower bolt, & other necessary hardwares etc as per the Manufacturers specifications / and detailed drawings/ as recommended by the Engineer in charge.				
12	PVC Pipe :Providing & fixing/laying PVC pipes confirming to I.S 4085-1960 & 1734-1975 of approved make (Prince/ Finolex/ Suprime) including all necessary specials like coller,bend ,Elbows, Tees,offsets, junctions, cowls, Nipples, Plugs laid under floor/under ceiling/on walls with suitable MS/PVC clamps with all lead and lift, all complete as directed by EIC. (Approved brand Prince, Finolex, Supreme)				
a	110 mm diameter (outlet for toilet)	RMT	50.00		
b	75 mm diameter(out let for floor/urinals/besin)	RMT	150.00		
13	Plumbing pipes : Providing & laying conceald/open SDR 11 rated CPVC pipe s including necessary testing , confirming to I.S specification with fittings such as Coller,Bend ,Elbows, Tees, Nipples, Plugs with cuts & threads for joint,with clamping wherever necessary, including cutting, threading, bending and similarworks, supply of clamps, small iron structures, spacersand installation of seats, plugs, bushings etc., small civil works, including all labour and materials, all lead & lift etc. complete as per specification, and as directed by engineer in charge.				

NIT Ref. COHUB: P&E:DPJ:6925:49: 2024-25 dated 26.12.2024

	a) 22.20 mm dia	RMT	150.00		
	b) 28.60 mm dia	RMT	150.00		
	c) 34.90 mm dia	RMT	200.00		
14	CPVC Ball valve: Providing & fixing CPVC Ball valve confirming to IS specifications including all lead & lift etc, complete as per drawings & as directed by the engineer in charge.				
	a) 25 mm diameter	EA	4.00		
15	EUROPEAN WATER CLOSET	EA	3.00		
	Supply and fixing of approved make glazed Wall/FLOOR mounted type European water closet , seat cover, flush valve, health facuet with angle cock. The closet to be mounted over C.I. chair bracket with flush valve consisting 32 mm dia control cock and wall flange and black or white solid seat cover of approved make with flap, rubber buffer, bolts, nuts and hinges all of approved make etc., complete. Rate includes following fittings & etc A) Water closet with cover (Basic cost of the product Rs. 21,690.00/-per unit), B) Hand Shower (Health Faucet) with 8mm Dia 1.2 Meter Long Flexible Tube and Wall Hook (Basic cost of the product Rs. 1,350.00/-per unit) C) Angle cock (Basic cost of the product Rs. 975.00/-per unit)				
16	WASH BASIN	EA	3.00		
	Supply and fixing of approved make White Coloured Wall hung Wash basin mounted over C.I. brackets and following CP brass fittings like 32mm CP waste coupling, flexible outlet pipe, 15mm CP brass long Body pillar cock with wall flange,1 no of 15mm CP brass angular stop cock with wall flange, one no.450mm long PVC inlet connecting pipes and 40mm OD PVC waste pipe class 3 (6 Kg/cm2) taken upto floor trap with necessary fittings etc., complete. Rate includes following fixtures & fittings of jaquar. A) Wash basin(Basic cost of the product Rs. 6400/-per unit/-per unit) B) Angle cock (Basic cost of the product Rs. 975.00/-per unit) C) Pillar Cock (Basic cost of the product Rs. 3,650.00/-per unit) D) Waste coupler (Basic cost of the product Rs. 440.00/-per unit) E) bott trap(Basic cost of the product Rs. 1,350.00/-per unit)				
17	URINALS	EA	3.00		
	Urinals : Providing laying & china clay urinals with flat black of approved make fix wall, cp brass bottle trap, pipe bends, painting white to exposed pipes dome waste coupling waste pipe etc., complete with all leads & lift, as per specification, darwings as directed by engineer in charge. (Rate includes cost of all material & lead.) Basic cost Rs. 7590/- Approved brand Jaquar, Grohe, Hindware ,parryware make only a) Angle cock (Basic cost of the product Rs. 975.00/-per unit)				

NIT Ref. COHUB: P&E:DPJ:6925:49: 2024-25 dated 26.12.2024

18	BIB COCK	EA	6.00		
	Providing & fixing CP brass metal Bib cock with wall flange long body, confirming to IS specifications , including all lead & lift etc, complete as per drawings & as directed by the engineer in charge. Basic cost of the product Rs.1250/-per unit				
19	TOWEL RAIL	EA	1.00		
	Providing and fixing approved quality chromium plated brass towel rail of 20mm dia 600mm length and 1.25mm thickness including fixing to wall with CP brass screws, finishing the same etc all complete as per EIC. Basic cost Rs. 2100/- per unit (Approved make Jaquar, Grohe)				
20	SOAP DISPENSOR	EA	0.00		
	Soap Dispenser with Glass Bottleetc Basic cost Rs. 1475/-per unit (make Jaquar, Grohe,Hindware)				
20	NAHANI TRAP	EA	3.00		
	Providing & fixing nahani trap inclusive of CP jali with hole , confirming to IS specifications with all lead & lift as per specification, drawing & as directed by the Engineer in charge Stainless steel for tiolet.				
21	GULLY TRAP	EA	2.00		
	Providing stone ware gully trap of approved quality including cover, jali etc & fixing in C.M 1:3 wherever necessary, as per specification, drawing & as directed by the engineer in charge. (Rate include cost of all material, fixtures & lead.) Size 15x 10 cms.				
22	MIRROR	SFT	9.00		
	Providing and fixing round edge mirror of 6mm thick float glass with 6mm thick water proof marine ply backing and rounded/ beveled edging , fixing on wall with wooden cleats and CP brass screws including cutting walls/ tiles , making good the same , finishing etc . all complete.	SQM			
Total Excluding GST					