

FILE NO:- 1188-2023

PROJECT.

EXISTING BANK BUILDING
& INTERIOR LAYOUT
PLAN OF THE
"**CANARA BANK**"
BRANCH - "**KAITHAL MAIN**"
HARYANA

OPTION :-02
DATE :- 03.06.2024 - MONDAY

SPACE FOR OFFICE USED:-

DETAIL OF AREA CHART

IN SQ.FTS.

CARPET AREA FOR BANK.	1914.87
CARPET AREA FOR ATM	0075.86
TOTAL CARPET AREA.	1990.73
CARPET AREA OF TOILET'S (NOT COUNTING IN CARPET AREA)	0053.71



CANARA BANK

FLOOR NO. - FIRST FLOOR

EXISTING HEIGHT WITHOUT SLAB:-
UP TO BEAM 10'-08"
FULL HEIGHT 11'-10"

ANY INQUIRY / INFORMATION TO
CONTACTS:- Er. ABDUL MANNAN
MOB. 09837933338-09997339956



Ar.MANMEET SINGH BAJAJ
M/S BAJAJ & ASSOCIATES
ARCHITECT, ENGINEERS PLANNERS & VALUERS,
SOPHIA MARKET COURT ROAD, SAHARANPUR-247001
TEL.No. - 0132-2724396, 098870-88908, 098370-23300
email- manmeet225@yahoo.com

CORPORATE OFFICE :- B-24 GROUND FLOOR
SEC-44, NOIDA-201301 (U.P.)
BRANCH OFFICE :- H.NO. 197/ 8 / 1 RAJPUR ROAD
DEHRADUN -248001 (U.K)
BRANCH OFFICE :- 333 LANE NO 02, SIYA RAM VIHAR
NEAR INDIAN OIL PUMP, TAKROHI,
INDIRA NAGAR,
LUCKNOW 226016 (U.P)

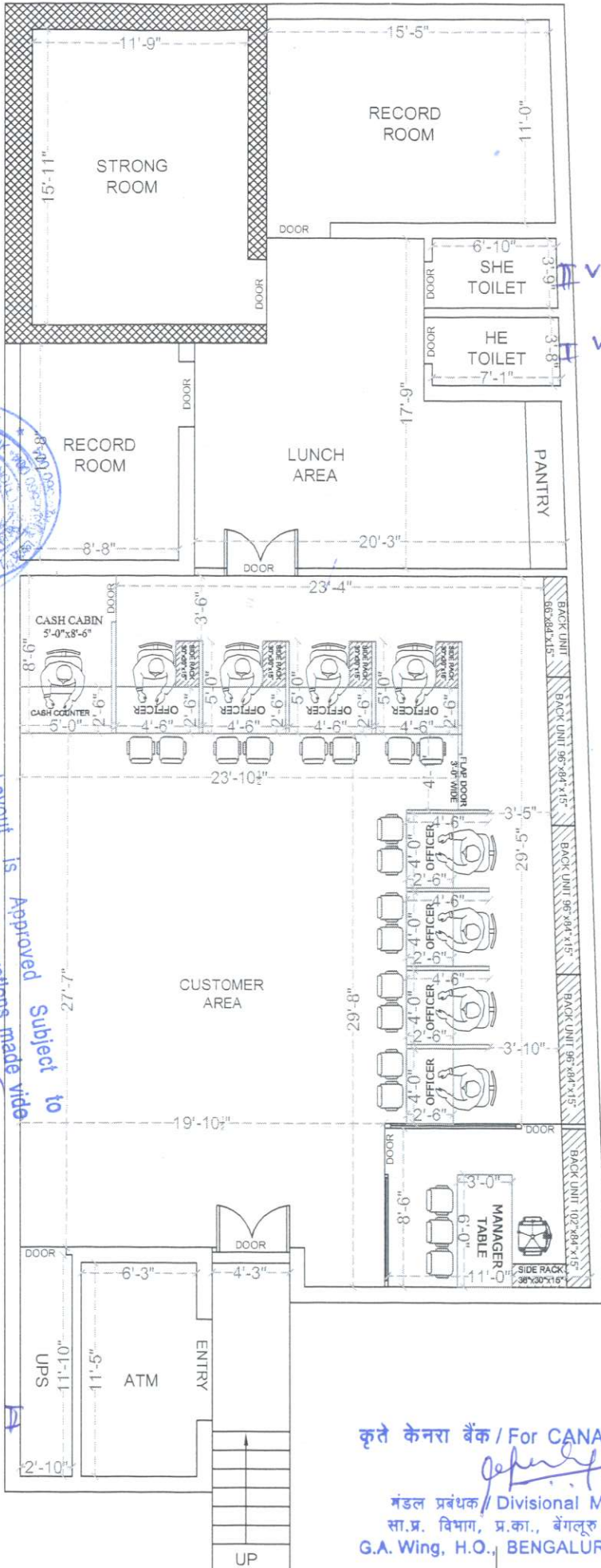

Date: 12/06/2024
Ref. No. 12/06/2024
Layout is Approved Subject to compliance of observations made vide 12/06/2024

कृते केनरा बैंक / For CANARA BANK

मंडल प्रबंधक / Divisional Manager
सा.प्र. विभाग, प्र.का., बंगलूरु - 560 004
G.A. Wing, H.O., BENGALURU - 560 004

Exist part.

ROAD