

OPTION - 04

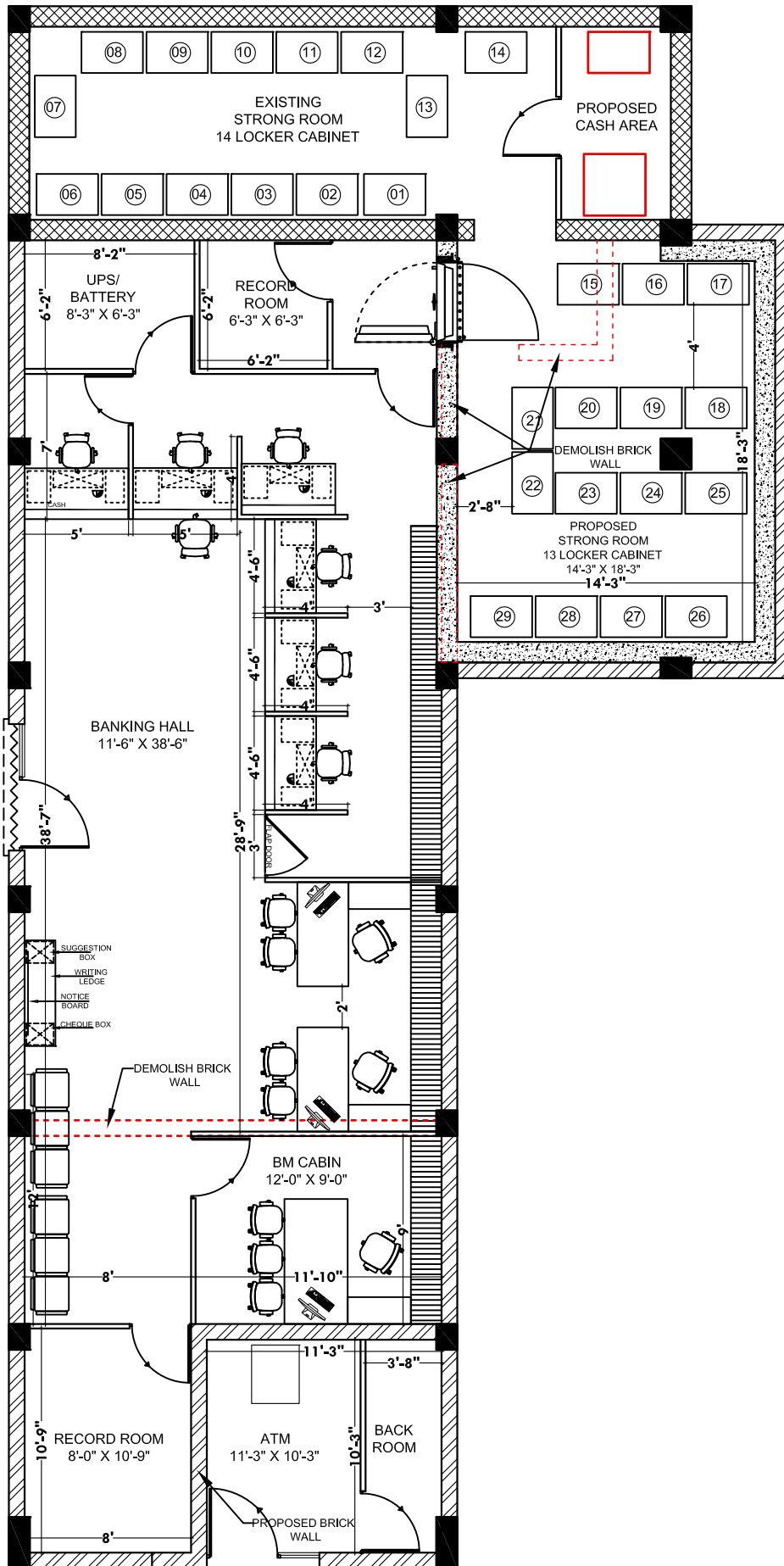

GENERAL NOTES:-

- THIS DRAWING IS THE PROPERTY OF ARCH DESIGN ARCHITECTS AND IS NOT TO BE USED FOR ANY PURPOSE OTHER THAN FOR WHICH IT IS ISSUED WITH OUT PERMISSION OF ITS PRINCIPALS.
- THIS DRAWING IS TO BE READ IN CONJUNCTION WITH OTHER RELEVANT ARCHITECTURAL, STRUCTURAL AND OTHER SERVICES/ CONSULTANTS DRAWING. IT SHALL BE THE DEEMED RESPONSIBILITY OF THE CONTRACTOR/ FABRICATOR TO BRING IN TO NOTICE OF ARCHITECTS IF ANY DISCREPANCY WITHIN OR BETWEEN THE DRAWINGS PRIOR TO CONSTRUCTION.
- ALL WRITTEN DIMENSIONS ARE TO BE FOLLOWED AND THE DRAWING IS NOT TO BE SCALED.
- NOTE- ALL DIMENSION ARE IN FEET UNTIL MENTION IN DWG

PROJECT:-

INTERIOR FURNISHING WORK
OF CANARA BANK
AT AWHO , GREATER NOIDA

DRAWING TITLE:-

PROPOSED INTERIOR LAYOUT PLAN
FOR GROUND FLOOR

SCALE:-

N.T.S.

DWG. NO.:-

ADA-CB-AWHO-01

DATE:-

05.08.2024

NORTH:-

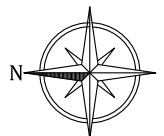

ARCH DESIGN
ARCHITECTS

ARCHITECTS, INTERIOR DESIGNER, PROJECT MANAGEMENT
H.O. :- C-32, MASAROVER PARK, NEW DELHI-32 B.O. :- GANPATI NIWAS,
CIVIL LINES, BULANDSHAHR-203001MOB: 9899227440, 9412857600.
Email :- archdes12@gmail.com