

OPTION-1

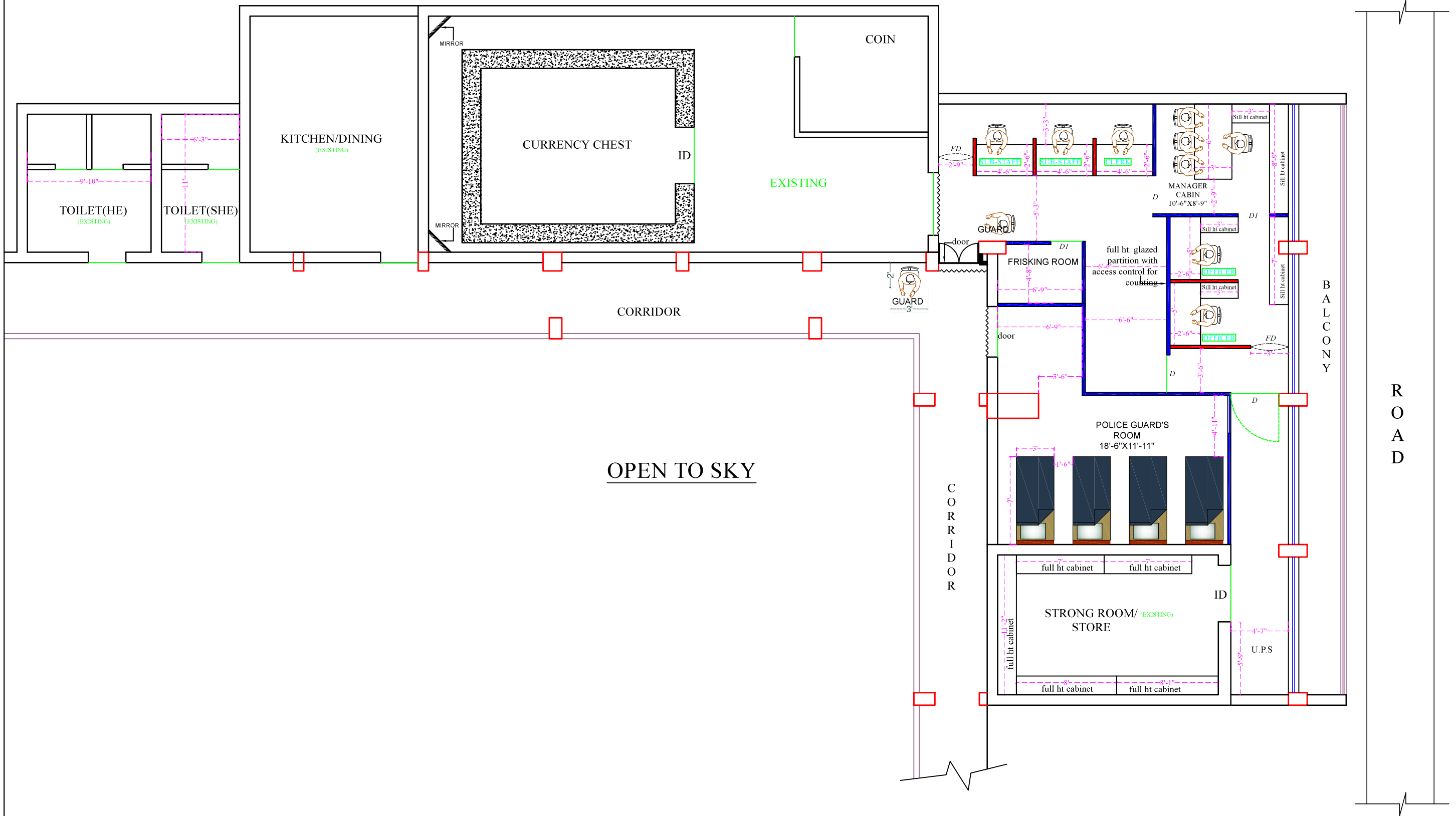

FIRST FLOOR PLAN

NOTES · All dimensions to be read not to be scaled. · This drawing supercedes all other previous drawings. · Dimensions are in inches except otherwise. · This drawing should be read in conjunction with relevant structural drawing and any discrepancy noticed should be got clarified before execution. · The drawing is the property of the architects. · Any copying or reproduction of this drawing should only be done after a written permission of the architects. · Any defaulter is liable to be sued for the violation of the copy right act.	LEGEND:- FULL HT. PARTITION HALF HT. PARTITION CASH CABIN PARTITION	DRAWN BY NIRAJ KUMAR		SHEET TITLE (ID-1)	PROJECT PROPOSED INTERIOR LAYOUT OF CURRENCY CHEST AT JAMSHEDPUR	STAMP	ARCHITECT
		CHECKED BY AR. SUNNY KUMAR		DATE 07-01-25	REVISION 02/13-01-25	DRAWING TITLE INTERIOR LAYOUT	CLIENT CANARA BANK