

PROJECT.

**MODIFIED BUILDING
& INTERIOR LAYOUT
PLAN OF THE
"CANARA BANK"
BRANCH - S.M.E KASHIPUR**

OPTION :-03

DATE :- 13-SEPT.2024 - FRIDAY

SPACE FOR OFFICE USE:-

DETAIL OF AREA CHART	in Sq.fts.
CARPET AREA AT GROUND FLOOR PLAN	1229.98
CARPET AREA FOR A.T.M	0056.76
TOTAL CARPET AREA.	1286.74
CARPET AREA OF TOILET (NOT COUNTING IN CARPET AREA)	0058.10

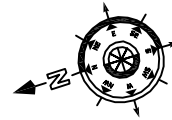

FLOOR NO. - GROUND & MEZZANINE FLOOR

EXISTING HEIGHT WITHOUT SLAB: -
UP TO BEAM -
FULL HEIGHT 13'-08"

ANY INQUIREY / INFORMATION
CONTACT TO: -Er.ABDUL MANNAN
MOB.09997339956,09837933338

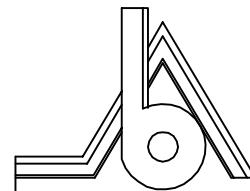

BAJAJ & ASSOCIATES
E S T D : 1 9 7 2

Ar.MANMEET SINGH BAJAJ

M/S BAJAJ & ASSOCIATES
ARCHITECT, ENGINEERS PLANNERS & VALUERS,
SOPHIA MARKET COURT ROAD, SAHARANPUR-247001
TEL.No.- 0132-2724396,098970-66906, 098370-23300
email- manmeet225@yahoo.com

CORPORATE OFFICE :- B-24 GROUND FLOOR

SEC-44,NOIDA-201301(U.P.)

BRANCH OFFICE :- (01)- H.NO. 197/ 8 / 1 RAJPUR ROAD
DEHRADUN -248001 (U.K)

(02)- 333 LANE NO 02, SIYA RAM VIHAR,
NEAR INDIAN OIL PUMP, TAKROHI,

INDIRA NAGAR, LUCKNOW 226016(UP)
(03)- H.NO. 5 / 1 A, Aman NAGAR, opp

DMW workshop,Patiala

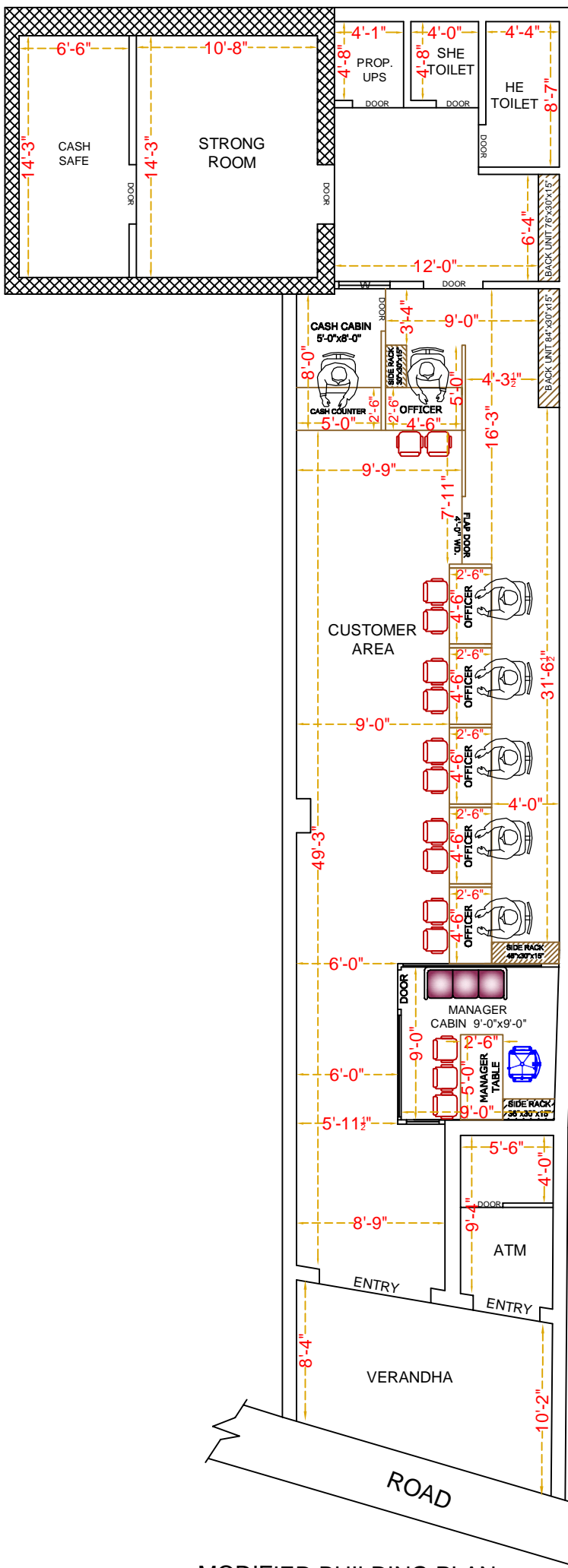

MODIFIED BUILDING PLAN