

**ATM AT GROUND FLOOR
SEPARATE FROM BRANCH**

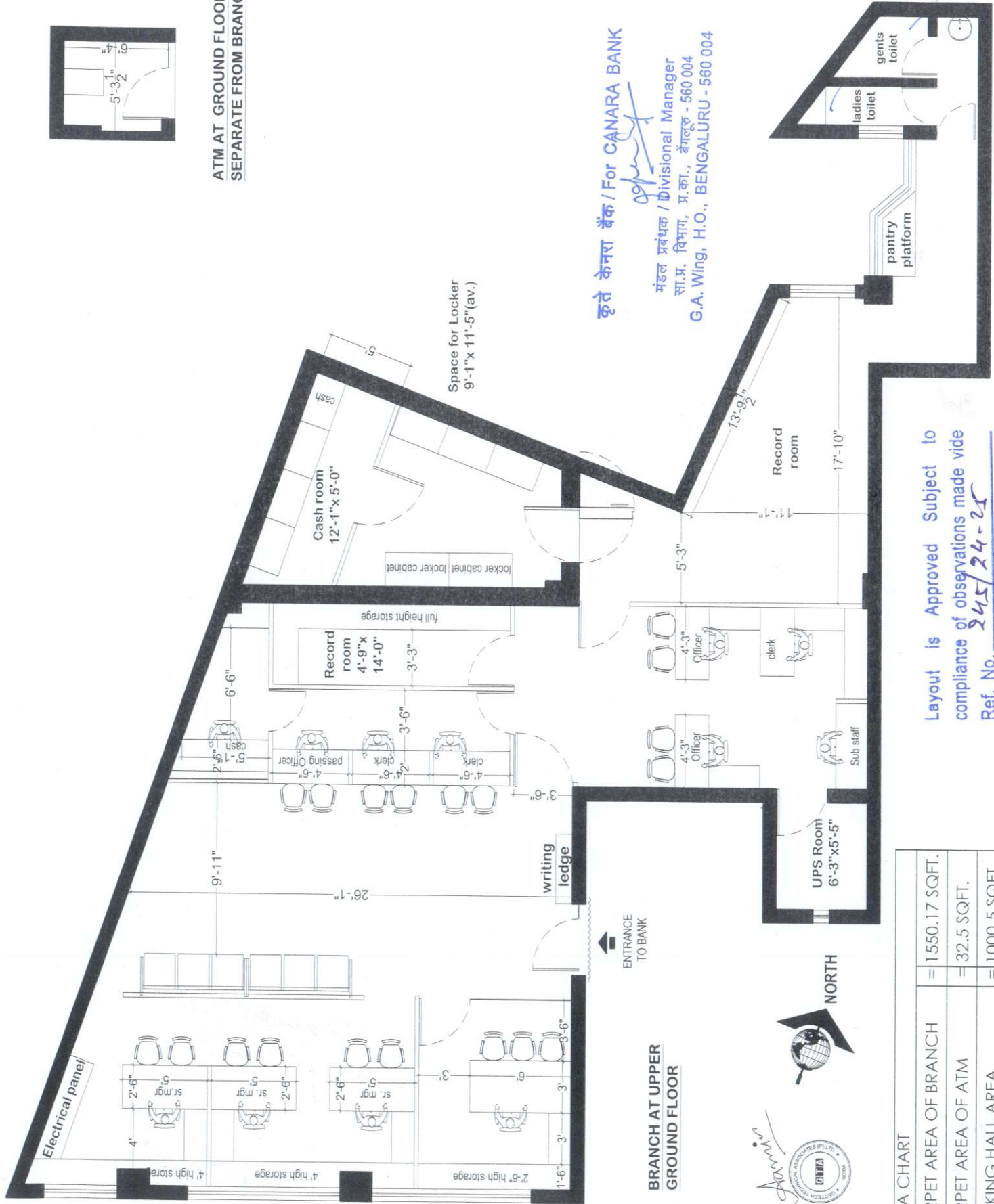

कुते केनरा बैंक / For CANARA BANK
 सहायक प्रबंधक / Divisional Manager
 सा.प्र. विभाग, प्र.का., बंगलूर - 560 004
 G.A. Wing, H.O., BENGALURU - 560 004

**BRANCH AT UPPER
GROUND FLOOR**

AREA CHART	
CARPET AREA OF BRANCH	= 1550.17 SQFT.
CARPET AREA OF ATM	= 32.5 SQFT.
BANKING HALL AREA	= 1000.5 SQFT.
CUSTOMER LOBBY AREA	= 502.05 SQFT.

Layout is Approved Subject to
 compliance of observations made vide
 Ref. No. 245/24-25
 Date: 09/15/24

- Notes**
- All dimensions are to be read and not be scaled.
 - Contractor must verify all dimensions as per site before commencement of any work.
 - Contractor must notify Architect and/or Project Manager of all discrepancies in the drawing & clarify with them.
 - All door and window openings are to be verified as per schedule.
 - All services to be co-ordinated with structures.
 - Contractor must take approval of layout from Architect before start of construction.
- Architects:

Geotech Technical Associates
 (P) LTD.
 B-004, Annapali Primely Estate,
 Sector - 76, Noida - 201301
 ph.: 9818838150, 9910297218
 e-mail: geotechassociates@gmail.com



CANARA BANK
 SUKRALI BRANCH,
 GURUGRAM

LAYOUT PLAN

Job No.	Drawing No.
Drawn	Checked
Date	Scale
Rev. No.	Revisions
10/07/24	CN-LU/AF/02