

OPTION- 04A

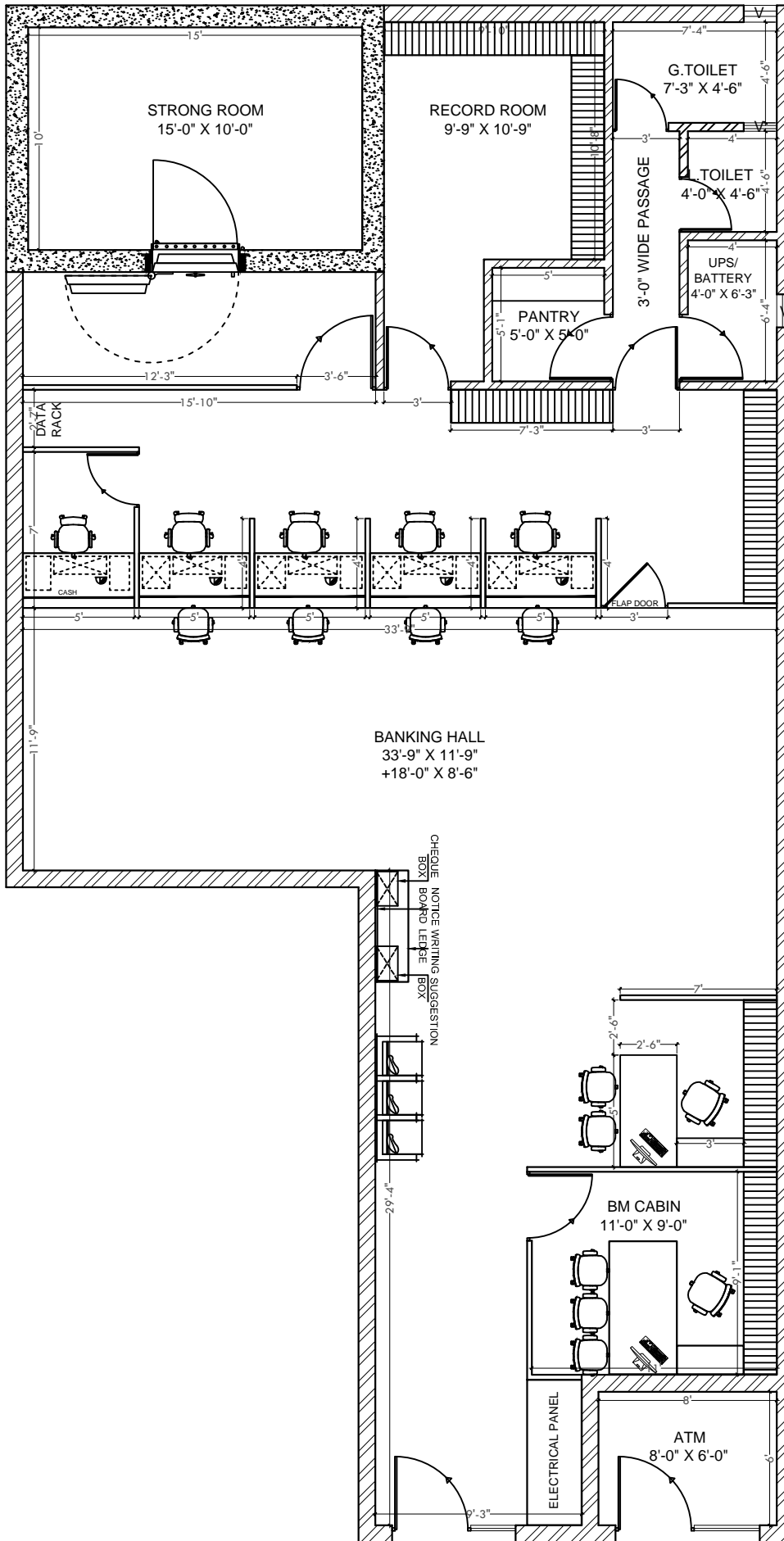

CARPET AREA : 1690.00Sqft.
 BANKING HALL AREA : 1315.00Sqft.
 CUSTOMER AREA : 700.00Sqft.

GENERAL NOTES:-

- THIS DRAWING IS THE PROPERTY OF ARCH DESIGN ARCHITECTS AND IS NOT TO BE USED FOR ANY PURPOSE OTHER THAN FOR WHICH IT IS ISSUED WITH OUT PERMISSION OF ITS PRINCIPALS.
- THIS DRAWING IS TO BE READ IN CONJUNCTION WITH OTHER RELEVANT ARCHITECTURAL, STRUCTURAL AND OTHER SERVICES/ CONSULTANTS DRAWING. IT SHALL BE THE DEEMED RESPONSIBILITY OF THE CONTRACTOR/ FABRICATOR TO BRING IN TO NOTICE OF ARCHITECTS IF ANY DISCREPANCY WITHIN OR BETWEEN THE DRAWINGS PRIOR TO CONSTRUCTION.
- ALL WRITTEN DIMENSIONS ARE TO BE FOLLOWED AND THE DRAWING IS NOT TO BE SCALED.
- NOTE- ALL DIMENSION ARE IN FEET UNTIL MENTION IN DWG

CLIENT:-

CANARA BANK,
 CIRCLE OFFICE KARNAL

PROJECT:-

INTERIOR LAYOUT PLAN
 FOR CANARA BANK AT
 DHANWAPUR

DRAWING TITLE:-

PROPOSED INTERIOR LAYOUT
 PLAN FOR GROUND FLOOR

SCALE:-

NORTH:-

DWG. NO.:-

N.T.S.

DATE:-

ADA-CB-DP-01

07.08.2024



**ARCH DESIGN
 ARCHITECTS**

ARCHITECTS INTERIOR DESIGNER LANDSCAPE CONSULTANTS
 GANPATI NIWAS, CIVIL LINES, BSR MOB: 9899227440, 9412857600, 8882829762