

**North**

**Stamp and Signature**

**Drawing For Review**

**Drawing Title**

Electrical Work

**Project Name**

Name Work :- Proposed Interior Work For  
Canara Bank @Makhmalabad RD , Panchavati,  
Nashik

**Consultant**

**ARCHITECTURE, INTERIOR DESIGN, VALUATION**

P.NO:-113,Sushanajli Bungalow D'souza Colony  
Near NDTA Tennis Court,Collage Road Nashik-422005  
email:- chougulearchitects@gmail.com  
Ph. 0253 2314920 MO.9823010920

Scale	Dimension	Drawn by	Checked By
NTS	Meter	Jitendra Wagh	Ar-Sheetal Chougule
Date	Drawing No.	Job No.	Revision
18/12/2023	Wrk-Dwg-01	CA-150-13	R-02

**Drawing Path**

E:\Jitendra\150\Canara Bank\13\Canara Bank@Makhmalabad RD,Panchavati,CA-150-13\Wrk-Dwg\01\_Electrical Layout\_Dwg\_CA-150-13.dwg

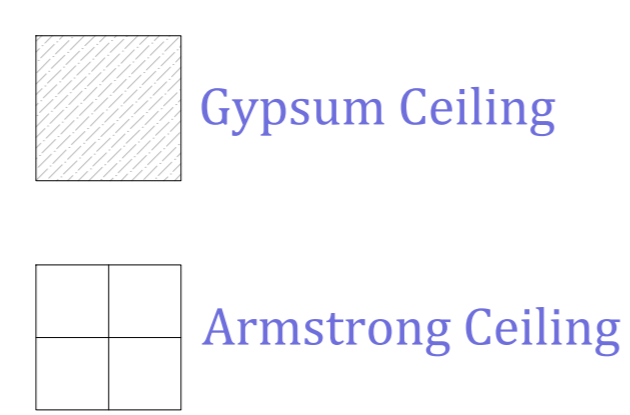

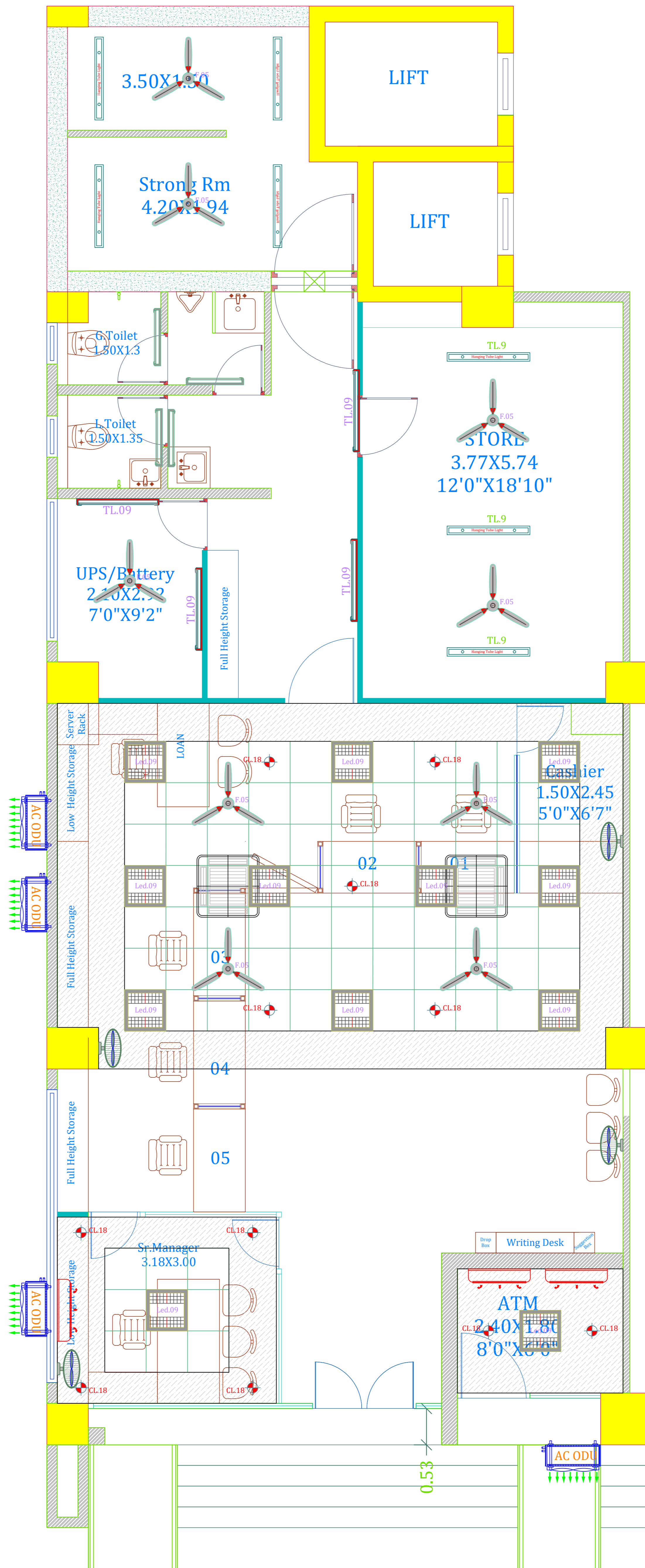

North

Stamp and Signature

**Drawing For Review**

**Drawing Title**

Electrical Work

**Project Name**

Name Work :- Proposed Interior Work For  
Canara Bank @Makhamalabad RD , Panchavati,  
Nashik

**Consultant**

**Chougule Architects**  
ARCHITECTURE, INTERIOR DESIGN, VALUATION  
P.NO:-113,Sushanajli Bungalow D'souza Colony  
Near NDTA Tennis Court,Collage Road Nashik-422005  
email:- chougulearchitects@gmail.com  
Ph. 0253 2314920 MO.9823010920

Scale	Dimension	Drawn by	Checked By
NTS	Meter	Jitendra Wagh	Ar-Sheetal Chougule
Date	Drawing No.	Job No.	Revision
18/12/2023	Wrk-Dwg-01	CA-150-13	R-02
Drawing Path	E:\Jitendra\150\Canara Bank\13\Canara Bank@Makhamalabad RD,Panchavati,CA-150-13\Wrk-Dwg\01_Electrical Layout_Dwg_CA-150-13.dwg		