

AREA STATEMENT	
AGM 02 & 03	NOS.
AGM	02
MARKETING CUBICAL	01
WORKSTATION	02
ASSURANCE CUBICAL	01
WORKSTATION	04
T.M CUBICAL	01
WORKSTATION	02
CALL CENTRE WORKSTATION	08
TOTAL	21 PERSONS

TOILET = 8.28SQ.M./ 89.14SQ.FT.  
TOTAL CARPET AREA = 109.775SQ.M./1181.62SQ.FT.

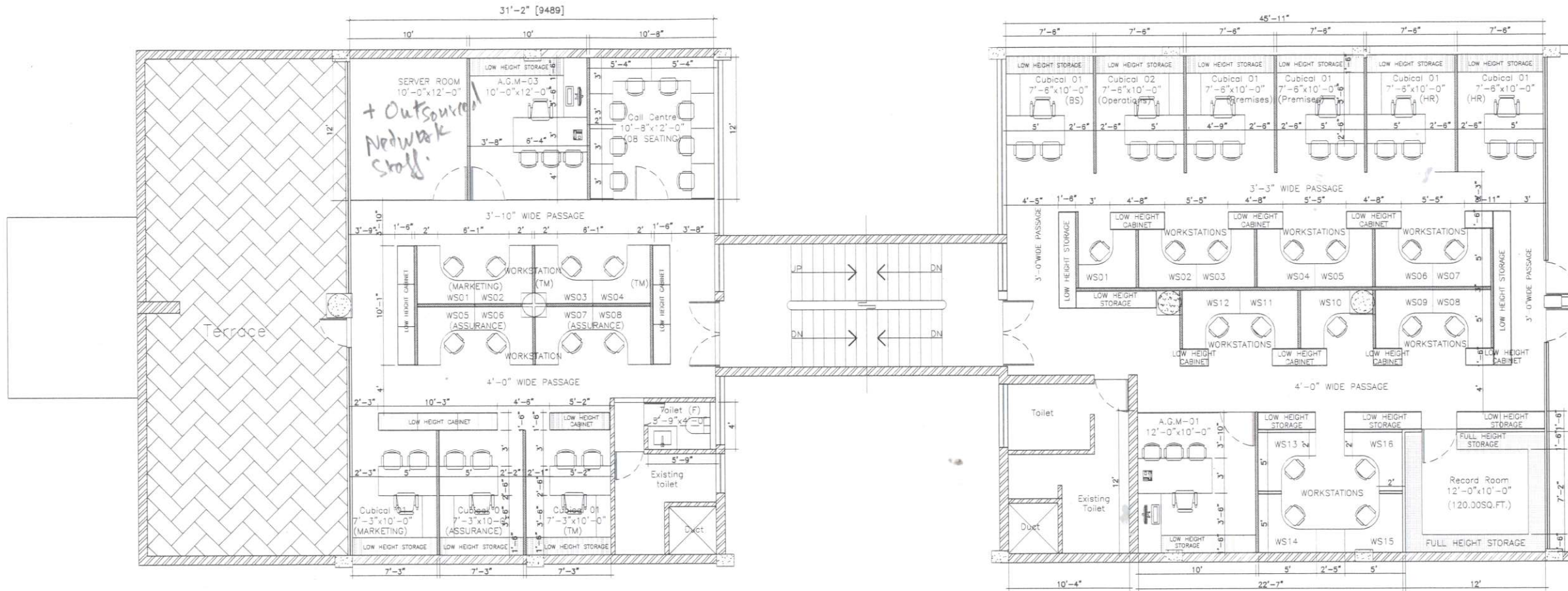

## 2nd Floor interior layout plan

\*Circle to ensure sufficient records space for all sections in other floors.

AREA STATEMENT	
AGM 01	NOS.
AGM	01
PREMISES CUBICAL	02
WORKSTATION	06
HR CUBICAL	02
WORKSTATION	04
OPERATIONS CUBICAL	01
WORKSTATION	04
BS CUBICAL	01
WORKSTATION	02
RECORD ROOM (226.05SQ.FT.)	
TOTAL	23PERSONS

TOILET = 11.74SQ.M./ 126.37SQ.FT.  
OFFICE CARPET AREA = 162.41SQ.M./1748.18SQ.FT.

4'-6" LOW HEIGHT PARTITION

8'-6" FULL HEIGHT PARTITION

TOTAL CARPET AREA = 2929.80SQ.FT.

### PROJECT :

INTERIOR FURNISHING WORKS OF CANARA BANK CIRCLE OFFICE, KARNAL (H.R)

### CLIENT NAME & ADDRESS :

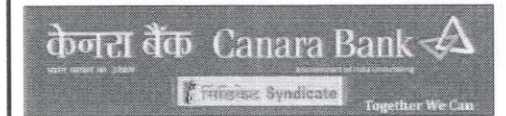

Circle office, Baysite 17-18, sec-12, karnal- 132001,  
Mob:- 90100-75111  
e,ail:- pecokar@canarabank.com

### CONSULTANTS NAME & ADDRESS :

**VaASTU Vikalp**  
Architects

Sh-24, First Floor, S2S Square, Garh Road, Meerut- 250002  
Ph:9899328602, 9997591118,  
vva.global@gmail.com

### ARCHITECT:

Ar. Rahul Chaudhary

### NORTH:



### DRAWING TITLE :

PROPOSED INTERIOR LAYOUT PLAN

### SHEET No

1/1

### DEALT :

Ar. Rahul Chaudhary

### CHECKED :

Ar. Manoj Kumar

### SCALE :

1:75

### DATE :

06Oct'2023

### DRAWING NO. :

VVA/BANK/CNR/CO-10.1

### OPTION/ REVISION

R-3

Layout is Approved Subject to compliance of observations made vide Ref. No. 441/23-24.  
Date: 29/09/2023.



कृते केनरा बैंक / For CANARA BANK

मंडल प्रबंधक / Divisional Manager  
सा.प्र. विभाग, प्र.का., बंगलूरु - 560 004  
G.A. Wing, H.O., BENGALURU - 560 004



Ref No.: 441/23-24

Circle Office, KARNAL premises

Dated 27/09/2023

Observations

S No	Observations
	We refer to your format dated 26.09.2023 re-submitting the KARNAL CO layout for our Approval. Our observations are as under:
1	The layout has been modified to accommodate curvilinear modular counters for staff and proposed call center staff for CO
2	Circle to take out the furnishing work only as per requirement.
3	Circle to exclude the 3feet length modular counters proposed by the architect as indicated in the layout.
4	Premises is Bank Owned Building & last furnishing date is mentioned as 2012.
5	The total carpet area of the CO is 6445 Sqft.
6	Circle to provide visitor seating for sections having frequent visitors viz GA Section, TM Section, Marketing, HR etc
7	Circle to ensure sufficient no. of separate Gents and Ladies washrooms with dual flush facility and running water facility during proposed renovation.
8	Circle to incorporate Green Building Principals to obtain IGBC Rating during proposed renovation.
9	CO to ensure that the seating arrangement is provided only to the required number of staff strength provided to the CO.
10	Electrical point for water dispenser shall be provided on all the Floors.
11	Circle to explore possibility of providing lift facility to 1st and 2nd Floors.
12	Uniform colour scheme to be followed/ensured as per brand manual.
13	Circle to ensure all non AC area to be properly cordoned to have better effect, life of AC and saving in electricity bill.
14	Proper distribution of electrical circuits to be made with provision for switching off while closing CO to avoid any fire incidents.
15	Circle to utilize the available area to optimum and provide facilities as per banks norms.
16	Circle to Ensure all the old records and obsolete furniture items are disposed from the premises before commencing the renovation works.
17	Circle to obtain Security Officer's Clearance for proposed layout changes.

Subject to compliance of the above observations in-principle approval for the lay-out is accorded.

For For CANARA BANK

मंडल प्रबंधक / Divisional Manager

सा.प्र. विभाग, प्र.का., बंगलूरु - 560 004

G.A. Wing, H.O., BENGALURU - 560 004

TMF.  
- 794512522 / Mail Sent - 29/09/23  
OB-382